

POLYESTER DACRON

A-A (1:8)

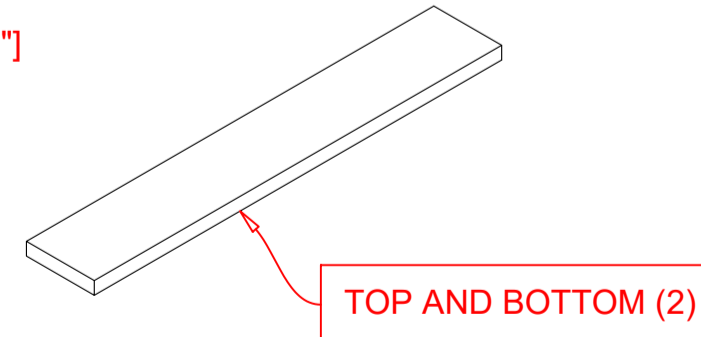

TOP AND BOTTOM (2)

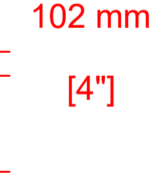
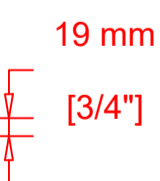
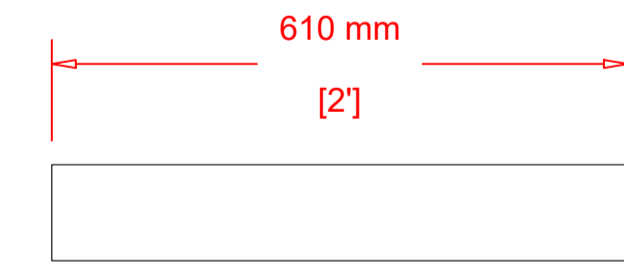
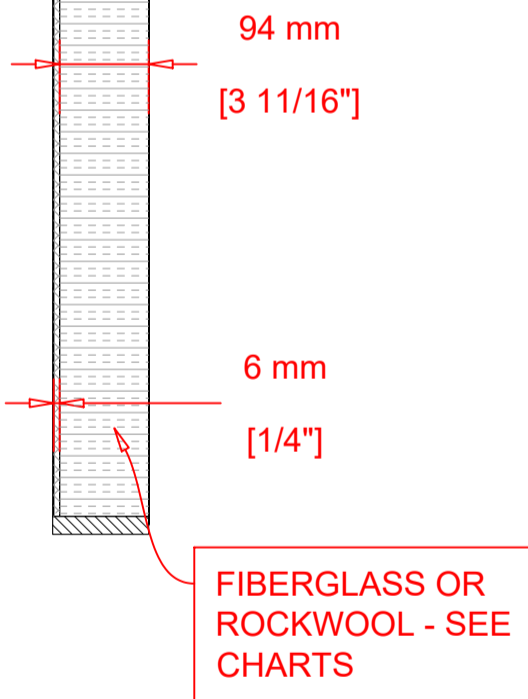
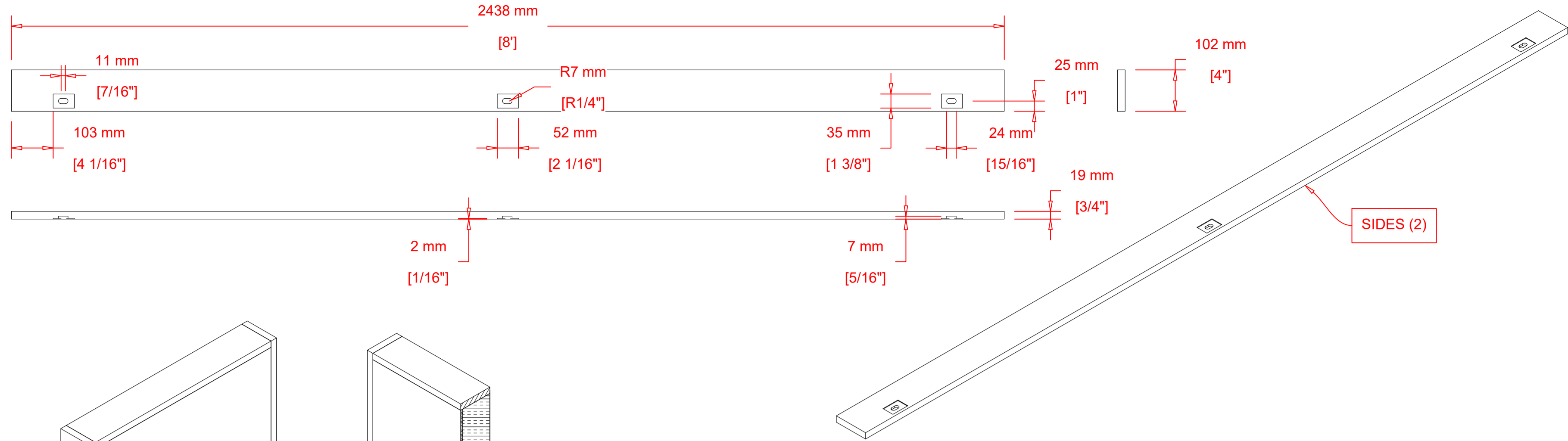
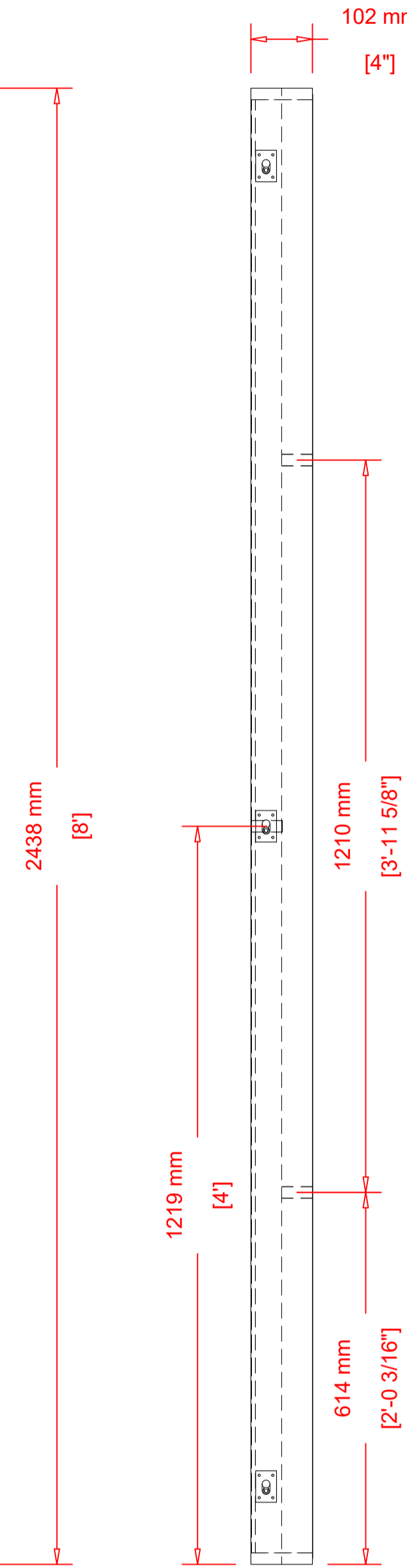
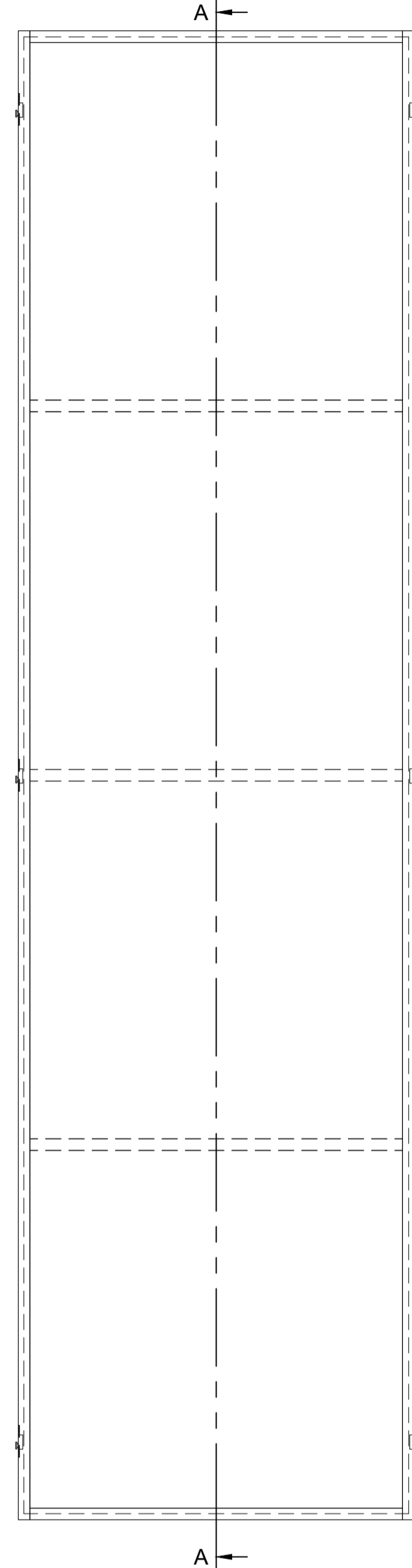
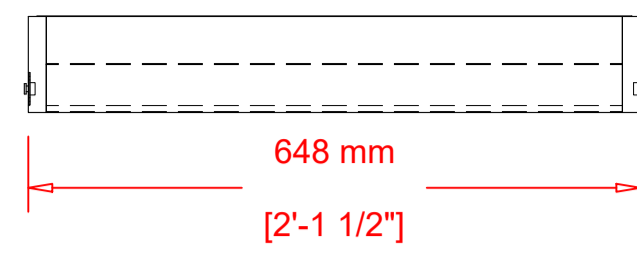
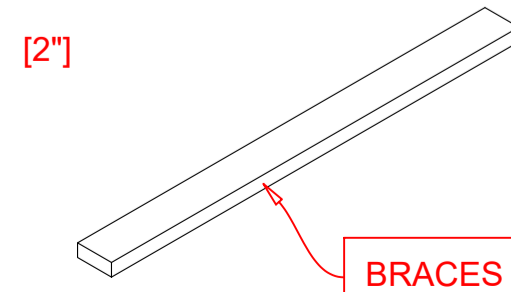
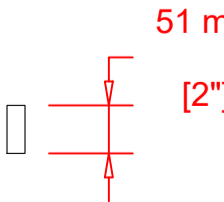
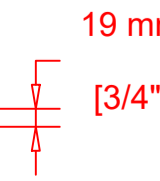
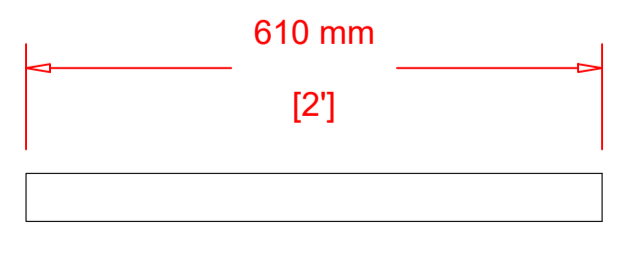

BRACES (3)

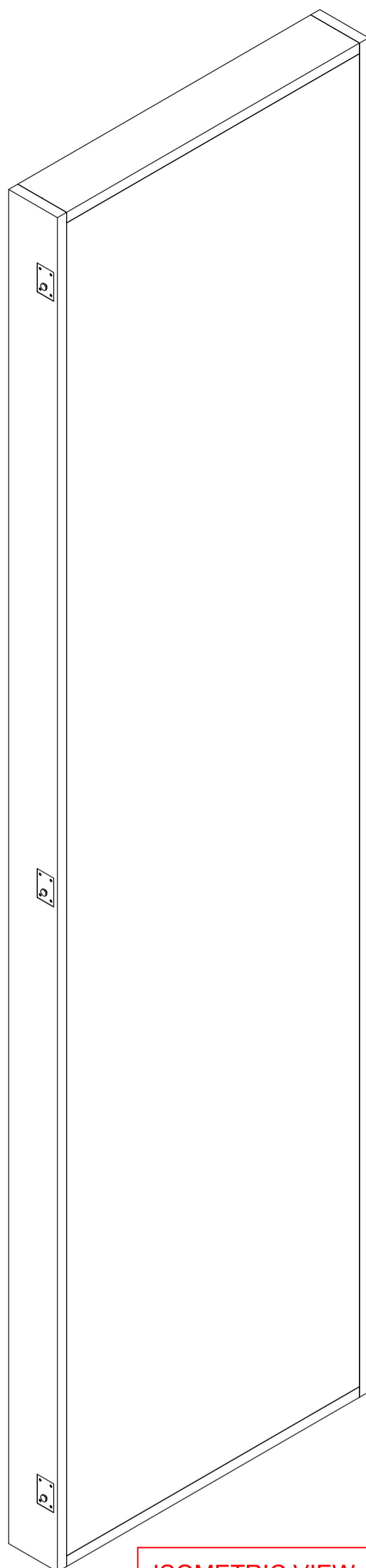
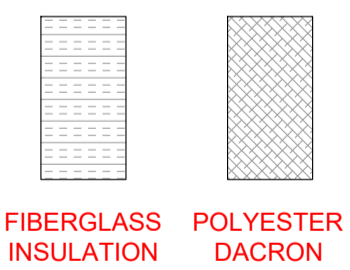

ISOMETRIC VIEW

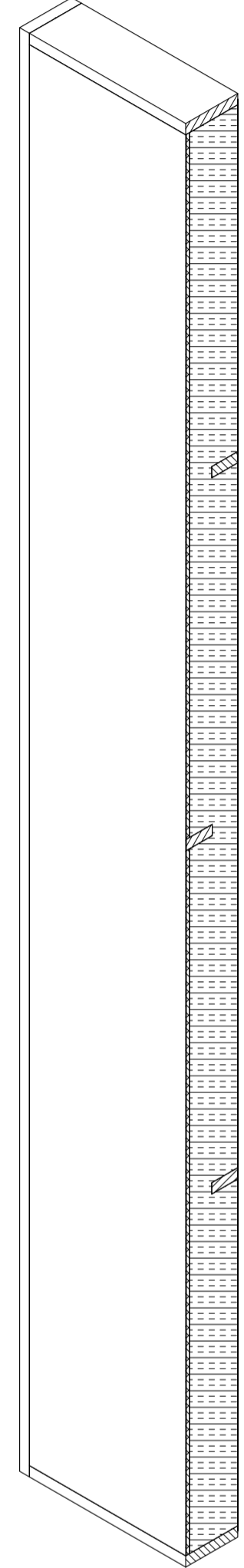

ISOMETRIC CUT-AWAY VIEW

NWAA Labs, Inc.
90 Tower Blvd,
Elma, WA 98541(253)-973-1018

Test #	NWAB20114	02	NRC	1.05
Test Date	2011-11-14		SCA	1.00
Absorbing per ASTM E105-06	A Mount			
Room Volume	11.1 m ³			
Room Conditions	Empty	Full		
Temperature °C	20	20		
Humidity %	100/50	100/50		
Barometric Pressure	1013.0	1013.0		
Humidity %	63	63		

Owens Corning, 10 by 12, FR703-4 inches

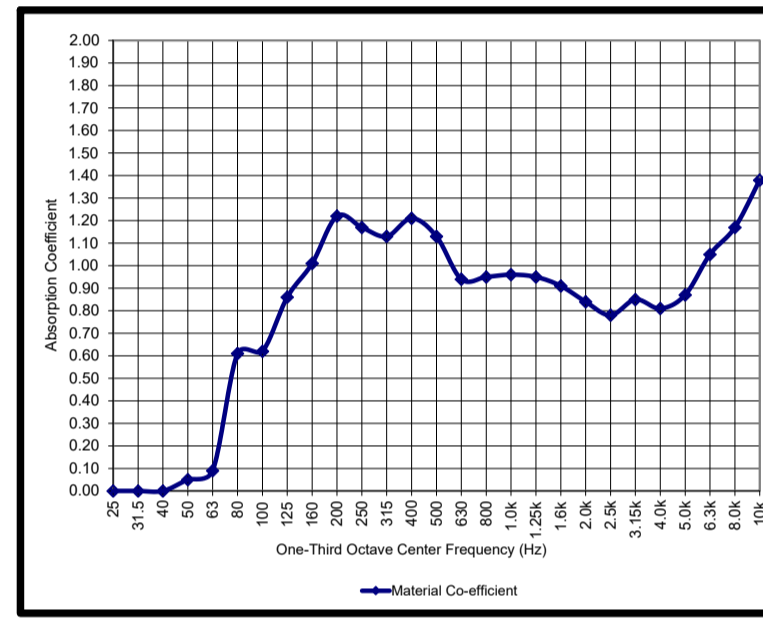

NWAA Labs, Inc.
90 Tower Blvd,
Elma, WA 98541(253)-973-1018

Test #	NWAB20208	01	NRC	1.00
Test Date	2012-02-08		SCA	1.01
Absorbing per ASTM E105-06	A Mount			
Room Volume	11.1 m ³			
Room Conditions	Empty	Full		
Temperature °C	20	20		
Humidity %	65/50	65/50		
Barometric Pressure	1013.0	1013.0		
Humidity %	63	63		

OC Pink, 10 by 12, 66 lbs den, 4 inch thick

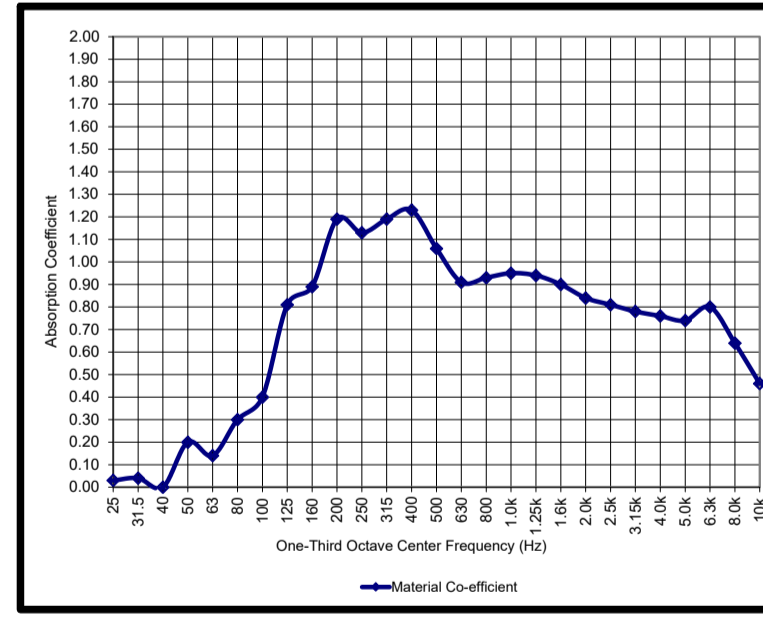

NWAA Labs, Inc.
90 Tower Blvd,
Elma, WA 98541(253)-973-1018

Test #	NWAB11206	02	NRC	0.93
Test Date	2011-11-06		SCA	0.90
Absorbing per ASTM E105-06	A Mount			
Room Volume	11.1 m ³			
Room Conditions	Empty	Full		
Temperature °C	20	20		
Humidity %	100/50	100/50		
Barometric Pressure	1013.0	1013.0		
Humidity %	62	63		

4 inch, HD Rockwool, 6 lb density per cubic foot, Area

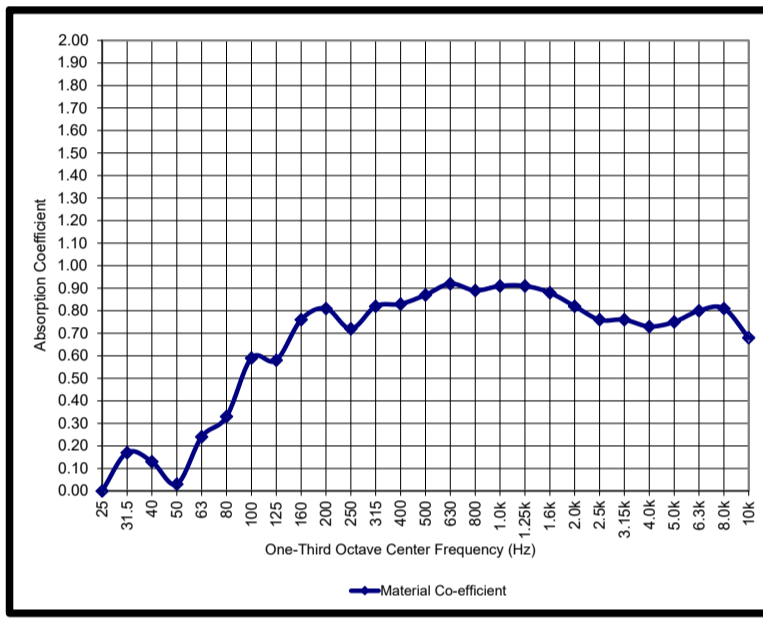

NWAA Labs, Inc.
90 Tower Blvd,
Elma, WA 98541(253)-973-1018

Test #	NWAB20210	02	NRC	0.93
Test Date	2012-02-10		SCA	0.91
Absorbing per ASTM E105-06	A Mount			
Room Volume	11.1 m ³			
Room Conditions	Empty	Full		
Temperature °C	20	20		
Humidity %	65/50	65/50		
Barometric Pressure	1013.0	1013.0		
Humidity %	63	63		

Owens Corning, 10 by 12, FR705-4 inches

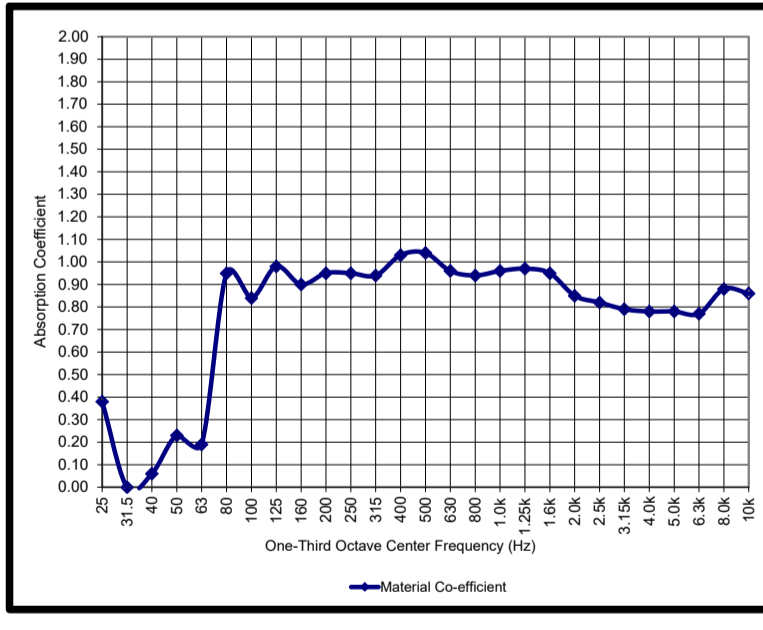

Use the recommended product from the charts on the right

THIS DRAWING IS PROPERTY OF JH BRANDT Recording Studio, Performance Hall, & Architectural Acoustics Consultants AND AS AN INSTRUMENT OF SERVICE, MAY NOT BE ALTERED, REPRODUCED, COPIED OR USED FOR CONSTRUCTION WITHOUT THE WRITTEN PERMISSION OF JH BRANDT. © 2020 all rights reserved.

Draftsman:	John H. Brandt	Date:	10/13/2020
Drafter:		Date:	
Drafter:		Date:	
Revision/Issue:		Date:	
Revision/Issue:		Date:	

This drawing is to be printed on standard A1 paper (564 mm X 841 mm) if not DO NOT SCALE. Scale Metric: 1 : 8

PARTS LAYOUT	
Job No : 10864	Project Date: 05/25/2020
Sheet :	

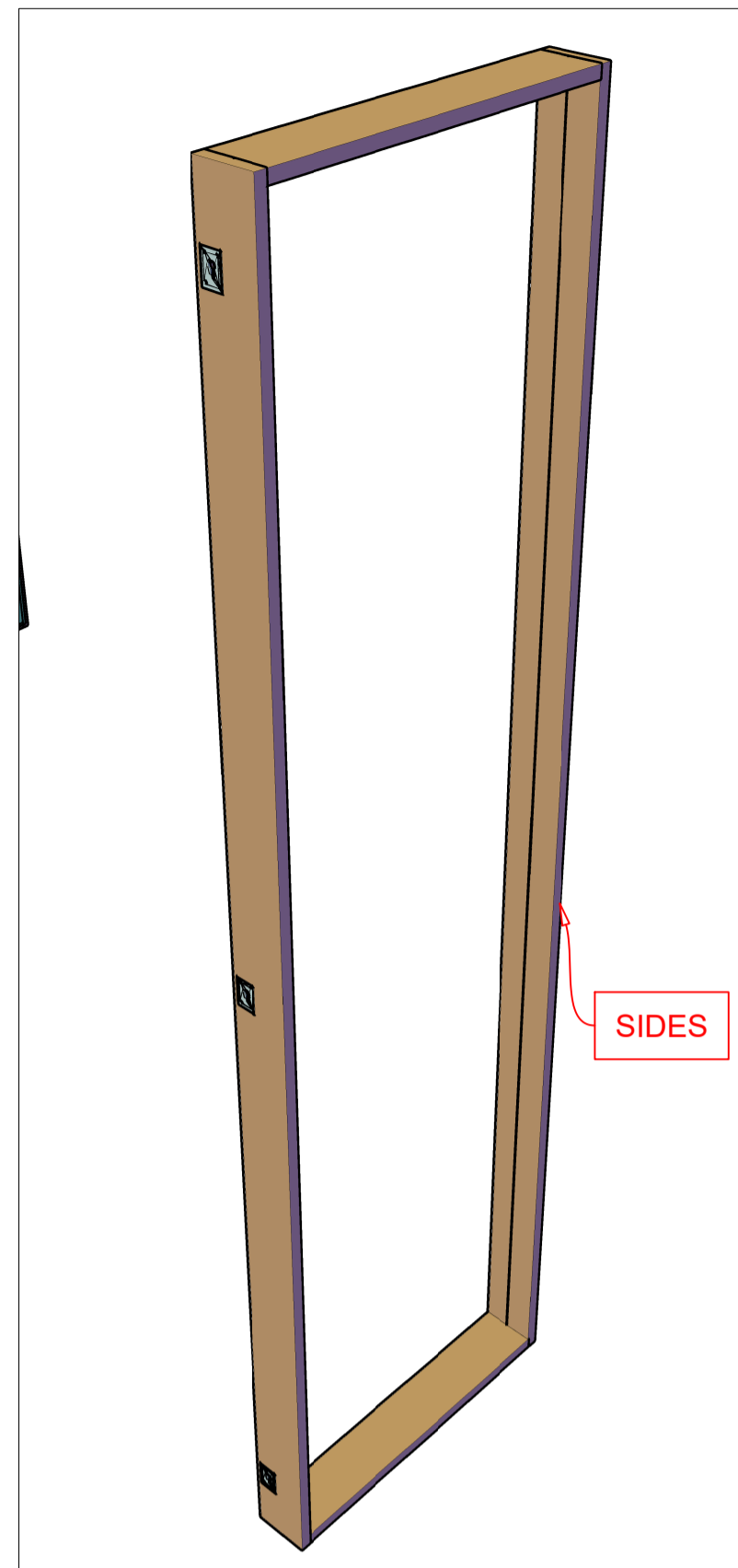

SIDES

1. ASSEMBLE TOP, BOTTOM, AND SIDES USING DOWELS AND GLUE. MAKE SURE THE UNIT IS 'SQUARE' (90 DEGREE CORNERS).

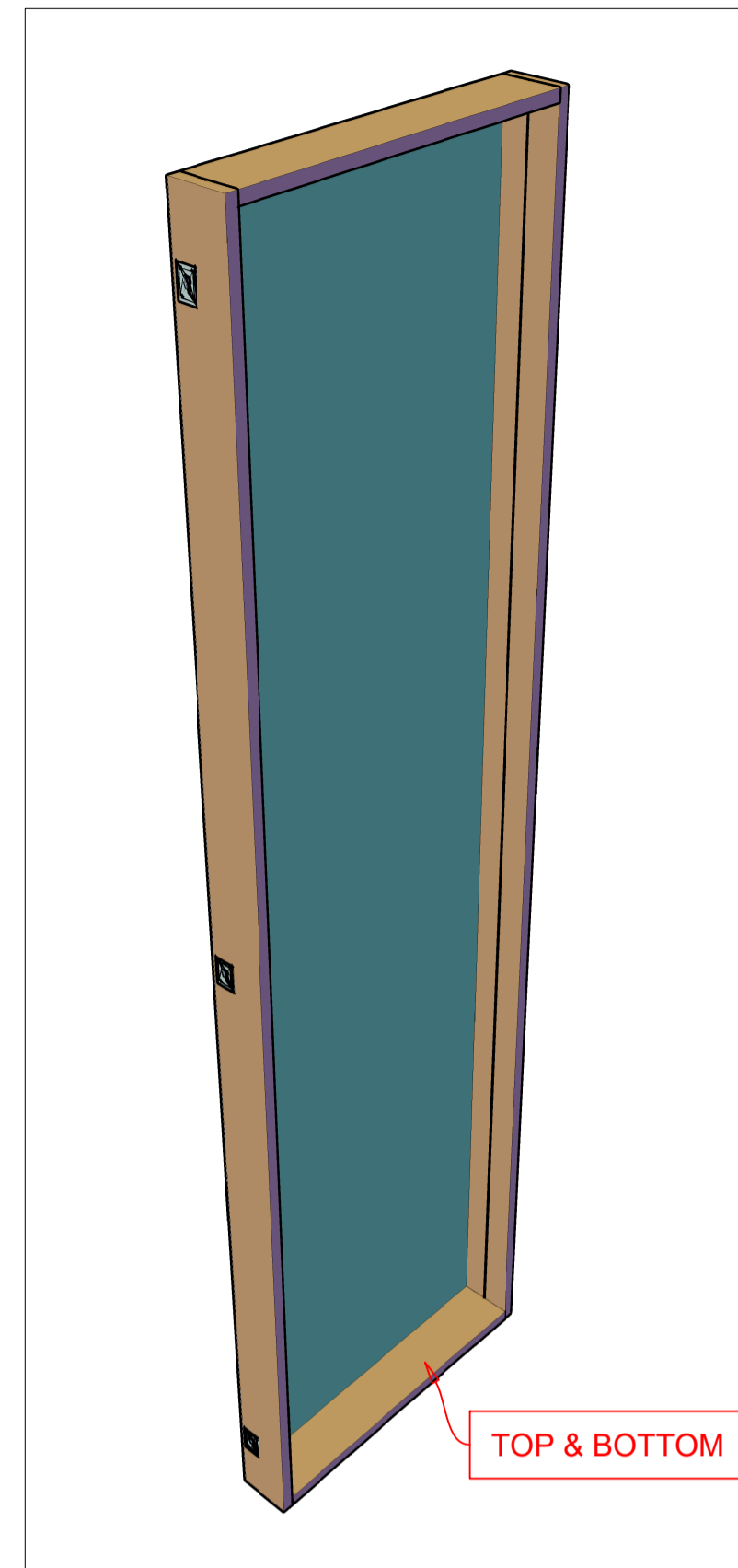

TOP & BOTTOM

2. ATTACH FABRIC TO THE INSIDE OF THE FRAME USING UPHOLSTERERS TAPE OR THIN STRIPS OF PLYWOOD.

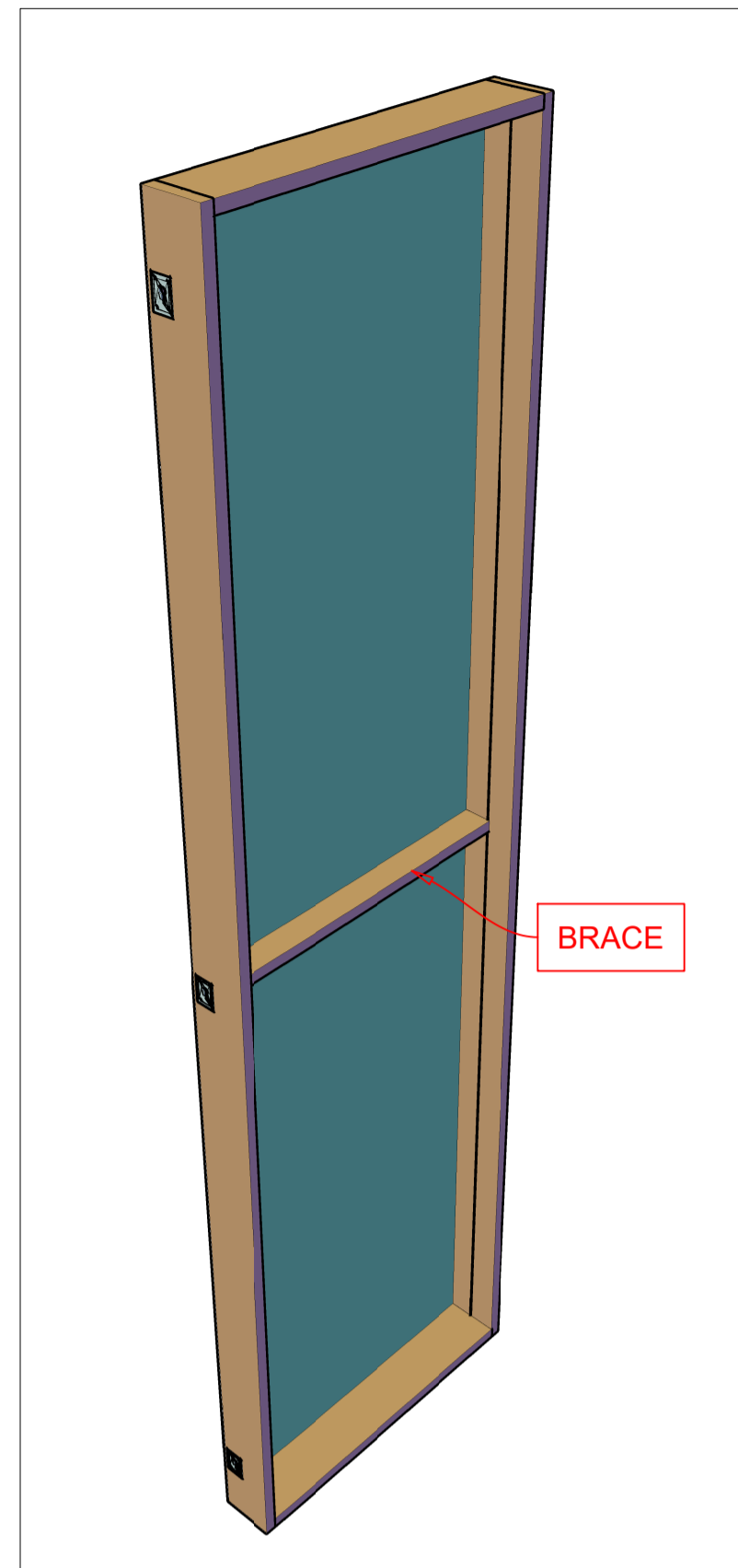

BRACE

3. ADD CENTER FRONT BRACE

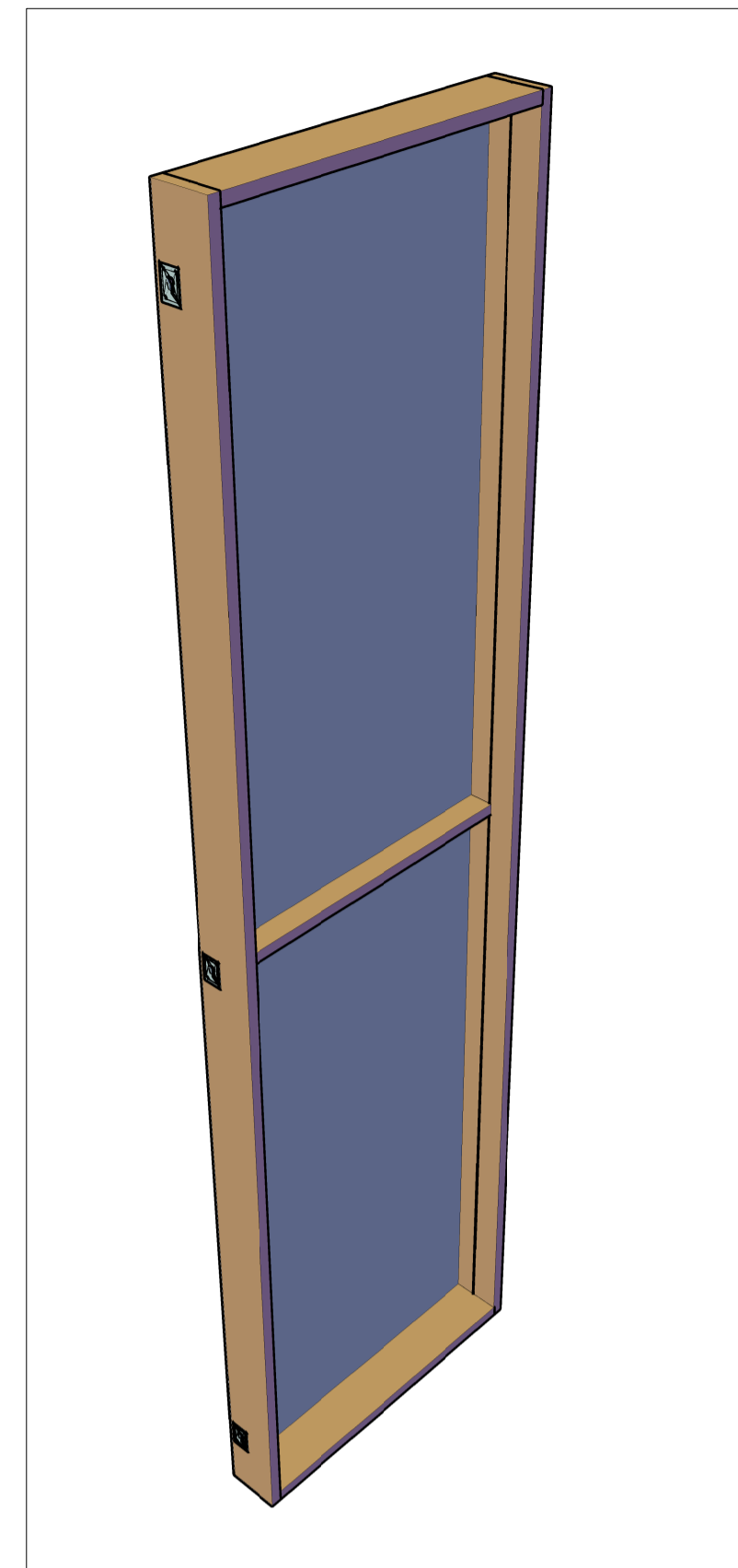

4. ADD 1/4" (6 mm) DACRON / POLYESTER BATTING AGAINST FRONT FABRIC



5. ADD REAR BRACING

SEE: Side-Panel Clamps and Doweling.pdf

ALL TREATMENT IS ASSEMBLED USING DOWEL AND GLUE METHOD

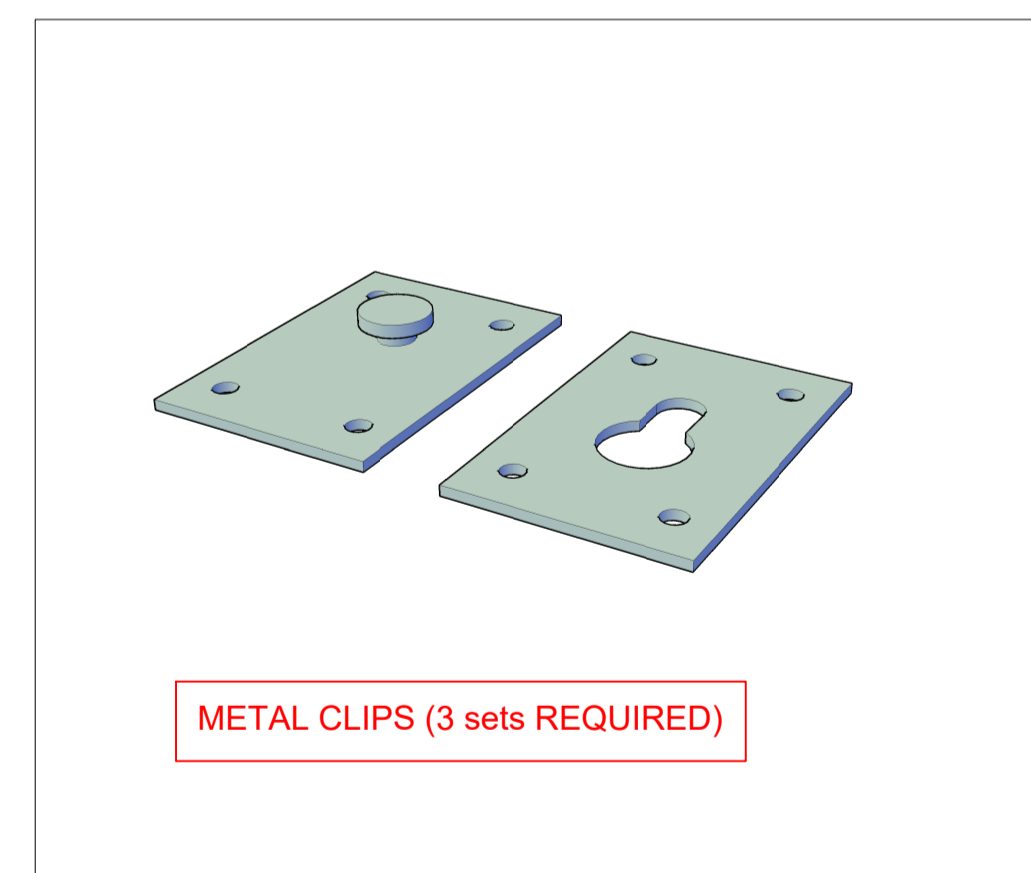

METAL CLIPS (3 sets REQUIRED)

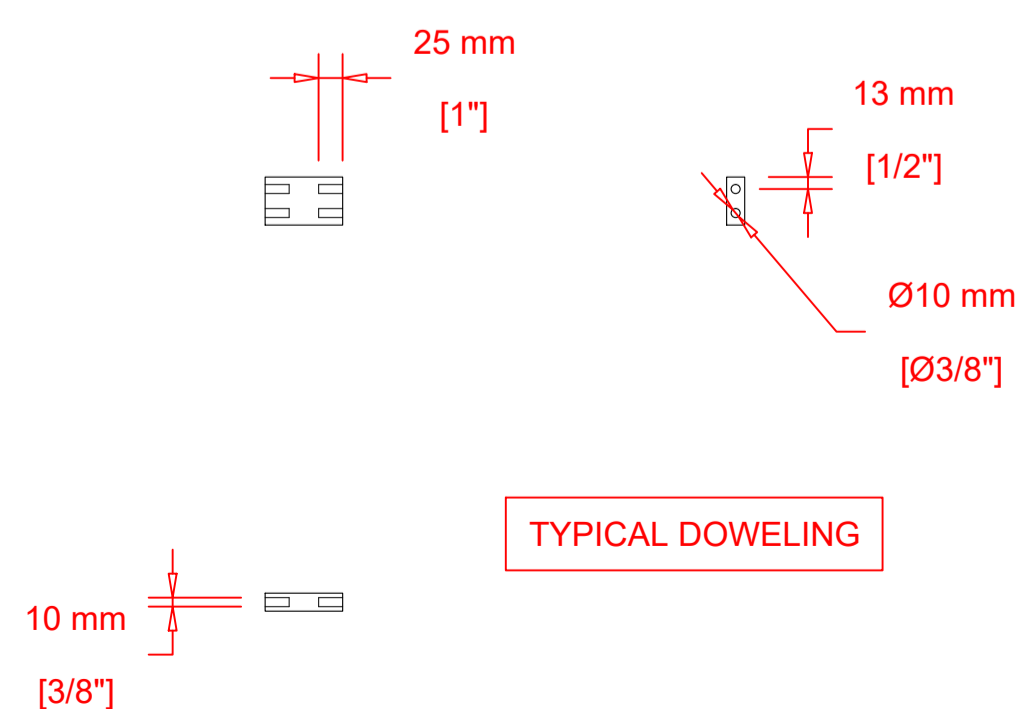

TYPICAL DOWELING

PIECE WITH DOWEL HOLES (TYPICAL)

SEE: Side-Panel Clamps and Doweling.pdf

6. INSTALL FIBER PRODUCT

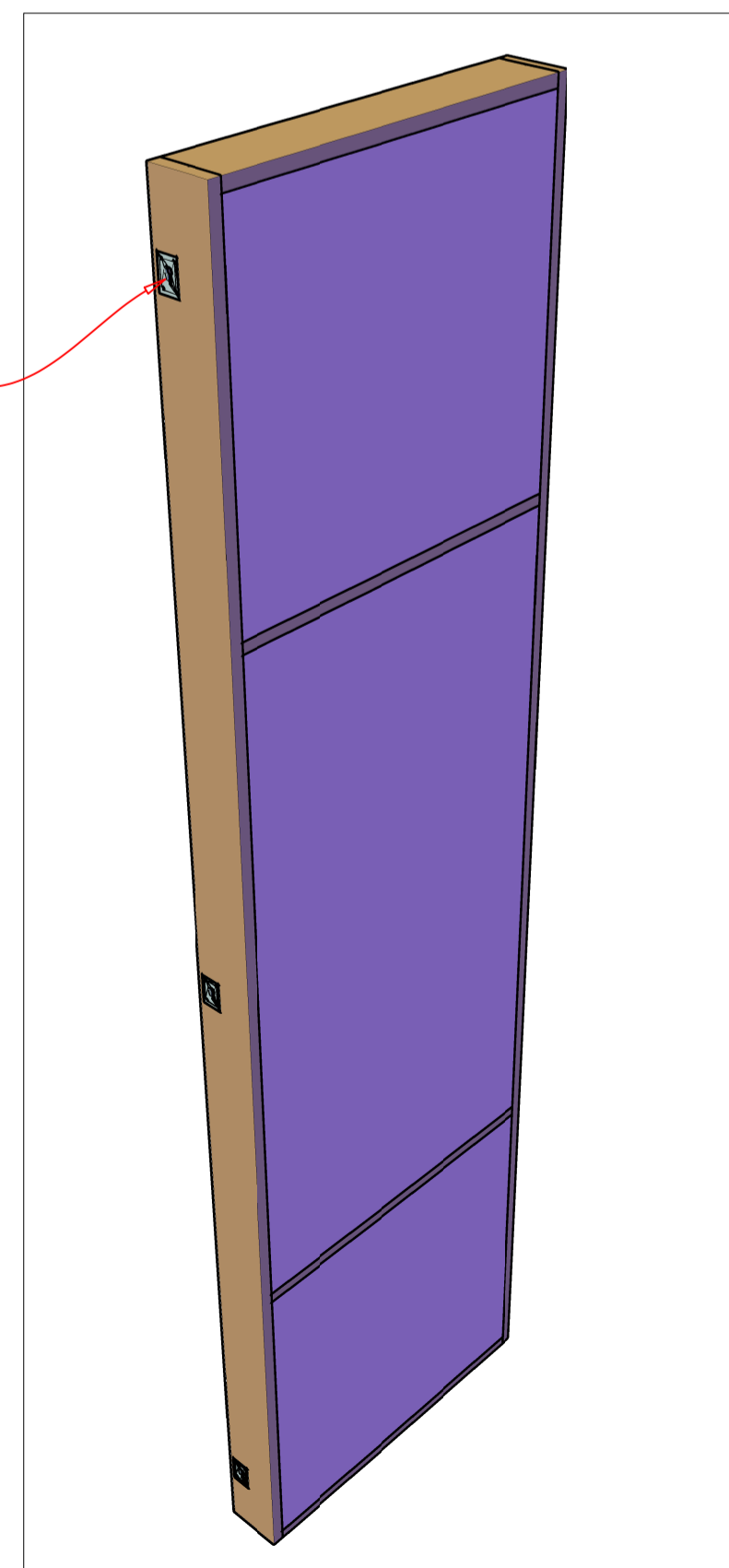

7. COVER THE BACK OF THE UNIT WITH INEXPENSIVE TICKING FABRIC TO KEEP THE COMPONENTS STABLE DURING SHIPPING AND INSTALLATION.

