

ISOMETRIC VIEW

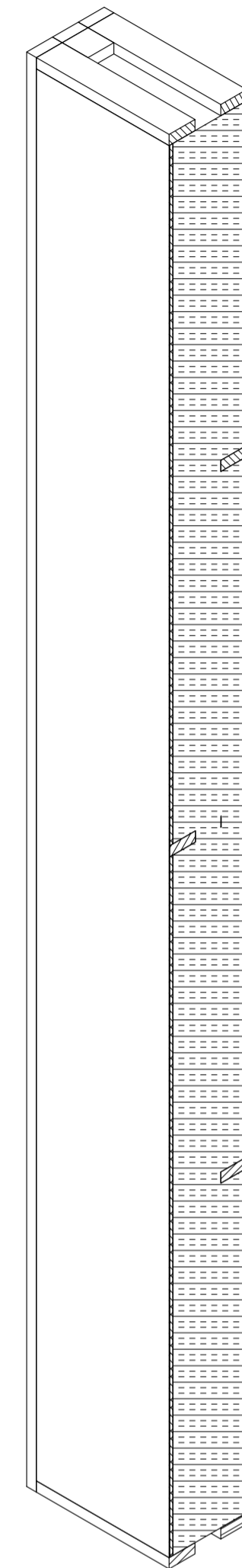

ISOMETRIC CUT-AWAY VIEW

Use the recommended product from the charts on the right

**NWAA Labs, Inc.**  
90 Tower Blvd,  
Elma, WA 98541(253)-973-1018

Test #	NWAA230314	03	NRC	1.00
Test Date	2023-03-11		SAA	0.99
ASTM per ASTM E755-00	A Mount			
Area tested (m <sup>2</sup> )	11.15			
Room condition	Empty	Full		
Temperature (°C)	20	21		
Humidity (%)	100/50	100/50		

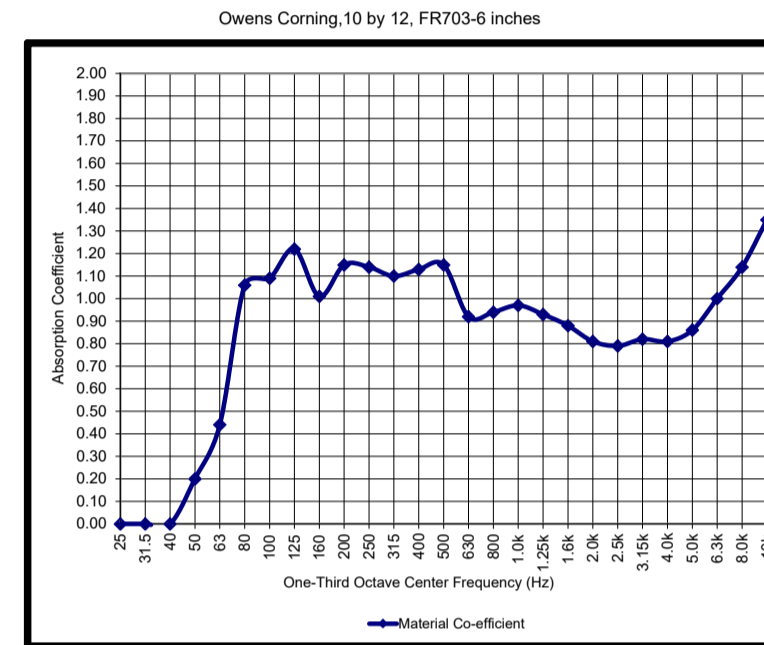

**NWAA Labs, Inc.**  
90 Tower Blvd,  
Elma, WA 98541(253)-973-1018

Test #	NWAA230309	01	NRC	0.90
Test Date	2023-03-08		SAA	0.89
ASTM per ASTM E755-00	A Mount			
Area tested (m <sup>2</sup> )	11.15			
Room condition	Empty	Full		
Temperature (°C)	21	21		
Humidity (%)	100/50	100/50		

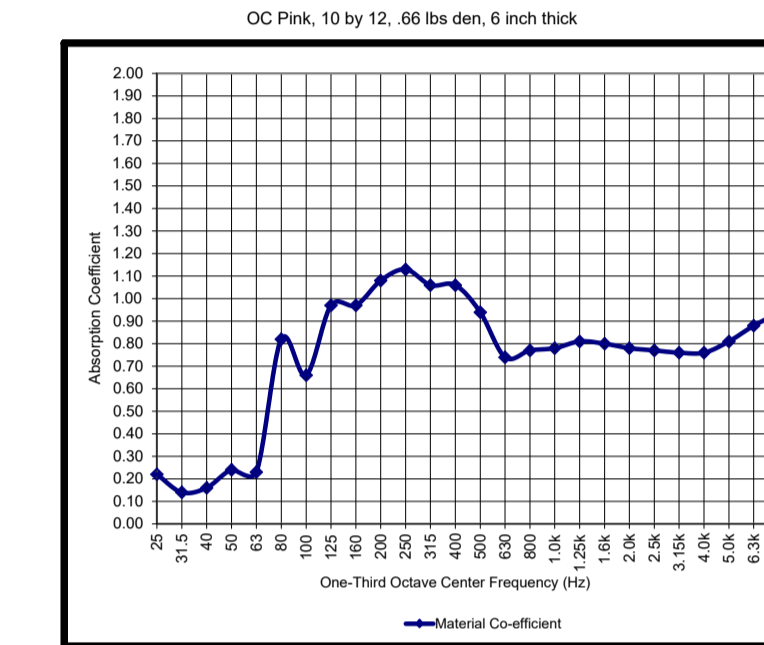

**NWAA Labs, Inc.**  
90 Tower Blvd,  
Elma, WA 98541(253)-973-1018

Test #	NWAA230310	03	NRC	0.88
Test Date	2023-03-10		SAA	0.88
ASTM per ASTM E755-00	A Mount			
Area tested (m <sup>2</sup> )	11.15			
Room condition	Empty	Full		
Temperature (°C)	21	21		
Humidity (%)	100/50	100/50		

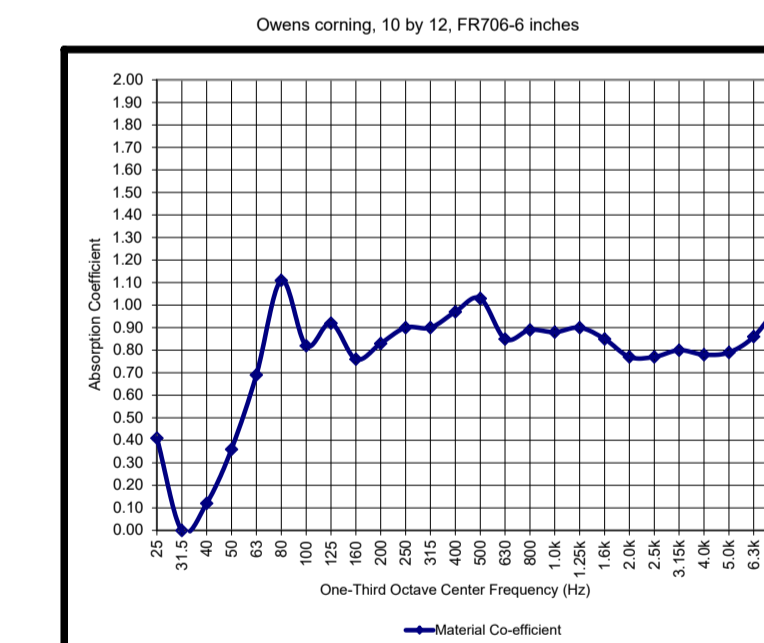

POLYESTER DACRON

A-A (1:8)

145 mm [5 11/16\"]

6 mm [1/4\"]

FIBERGLASS OR ROCKWOOL - SEE CHARTS

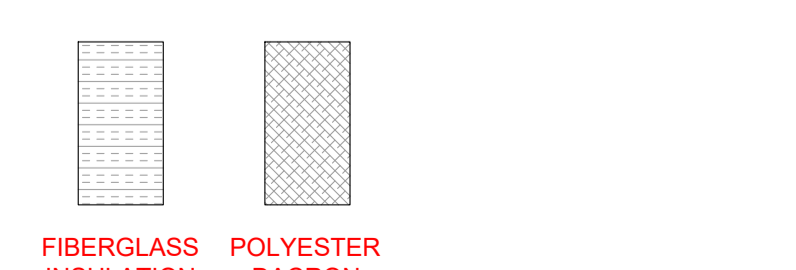
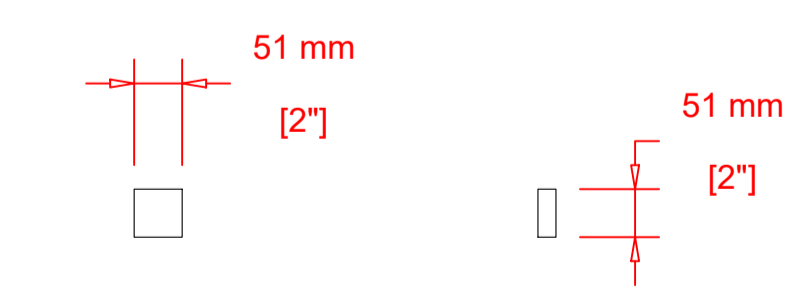

SIDE & CORNER BLOCKING (10)

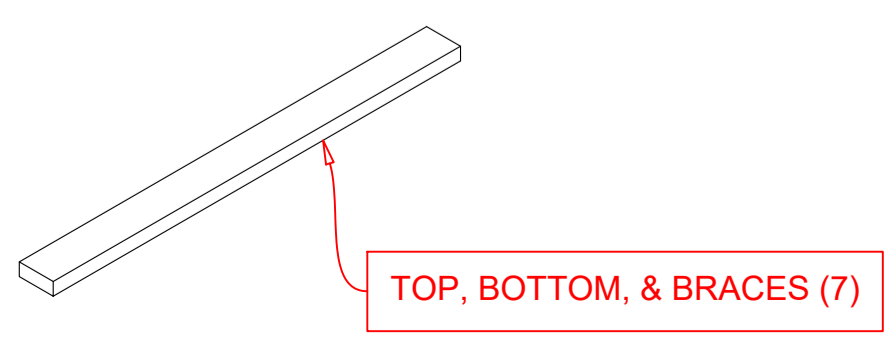
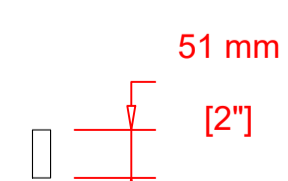
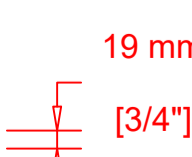
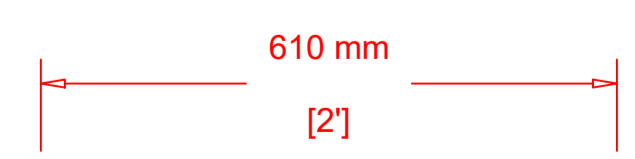

TOP, BOTTOM, & BRACES (7)

106

Recording Studio, Performance Hall, & Architectural Acoustics Consultants  
**JH BRANDT**  
Summarecon Bekasi, Cikarang, Bekasi, West Java, Indonesia  
email: jhbrandt@jhbrandt.net  
Tel: +62 21 205 734 88 / +62 201 7771 9798  
web site: http://www.jhbrandt.net

THIS DRAWING IS PROPERTY OF JH BRANDT Recording Studio, Performance Hall, & Architectural Acoustics Consultants AND AS AN INSTRUMENT OF SERVICE, MAY NOT BE ALTERED, REPRODUCED, COPIED OR USED FOR CONSTRUCTION WITHOUT THE WRITTEN PERMISSION OF JH BRANDT. © 2020 all rights reserved.

Draftsman:	John H. Brandt	Date:	05/25/2020
Draftsman:		Date:	
Draftsman:		Date:	
Revision/Issue:		Date:	
Revision/Issue:		Date:	

This drawing is to be printed on standard A1 paper (564 mm X 841 mm) if not, DO NOT SCALE. Scale Metric: 1 : 8

PARTS LAYOUT

Job No : 10864 Project Date : 05/25/2020

Sheet :

1 of 2

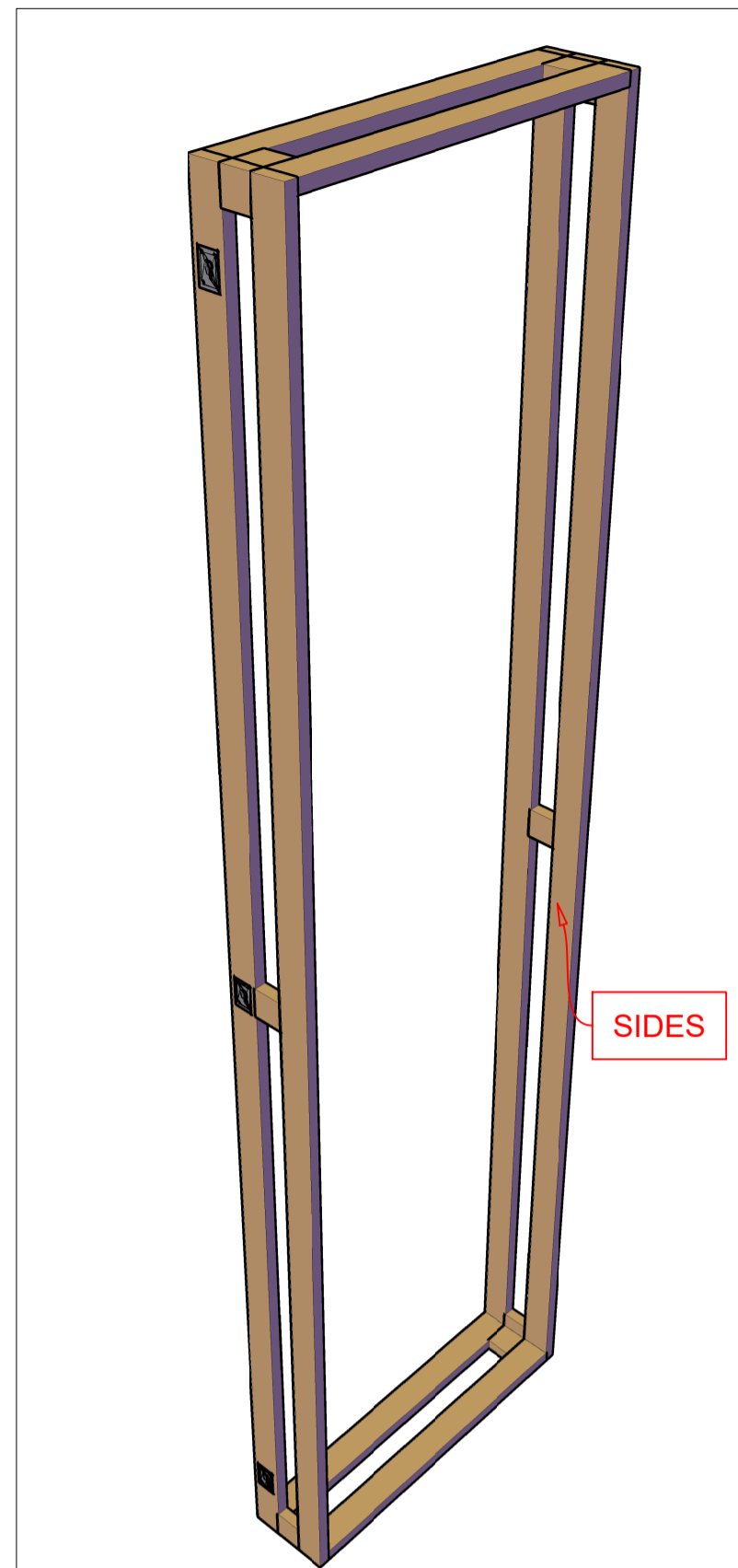

SIDES

1. ASSEMBLE TOP, BOTTOM, AND SIDES USING DOWELS AND GLUE. MAKE SURE THE UNIT IS 'SQUARE' (90 DEGREE CORNERS).

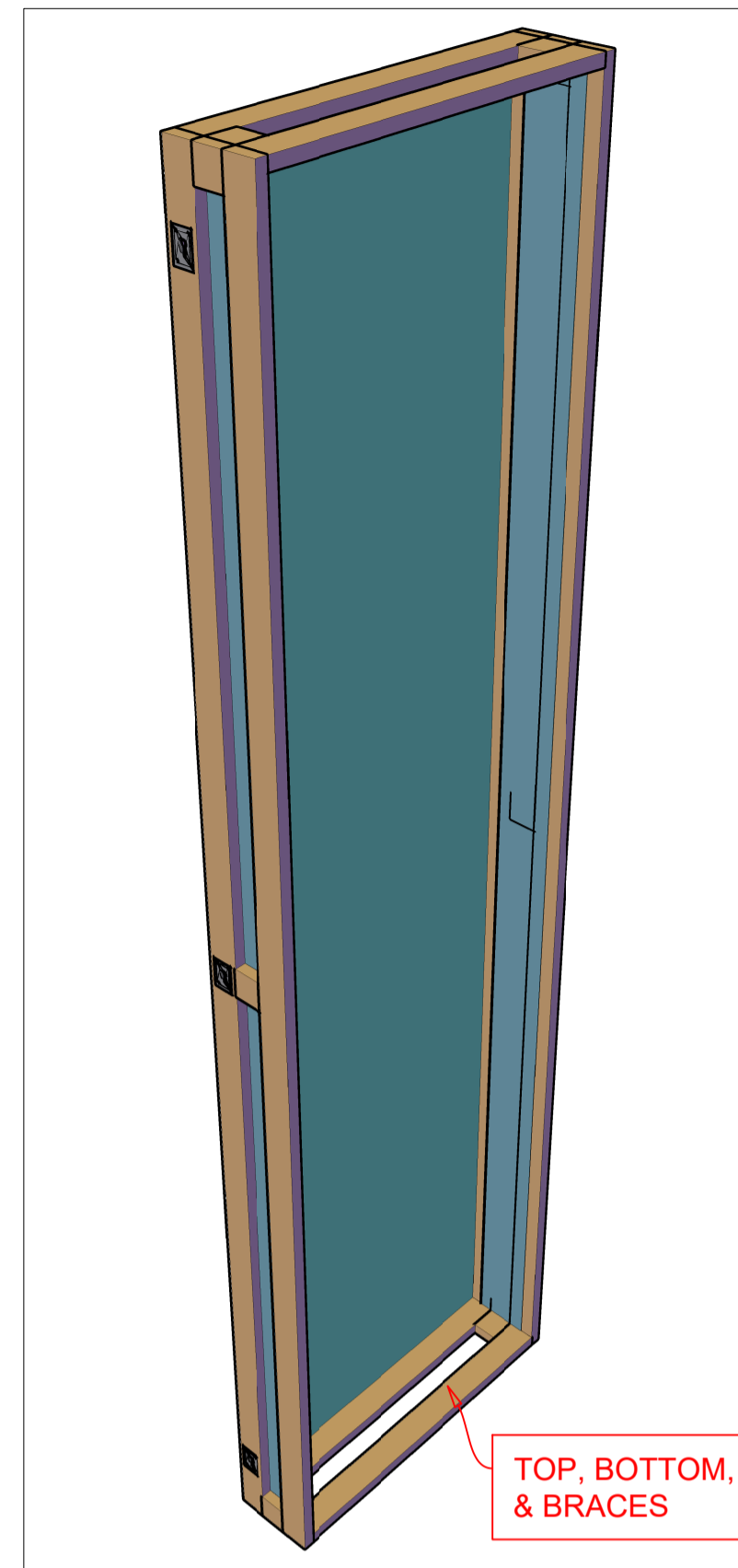

TOP, BOTTOM, & BRACES

2. ATTACH FABRIC TO THE INSIDE OF THE FRAME USING UPHOLSTERERS TAPE OR THIN STRIPS OF PLYWOOD.

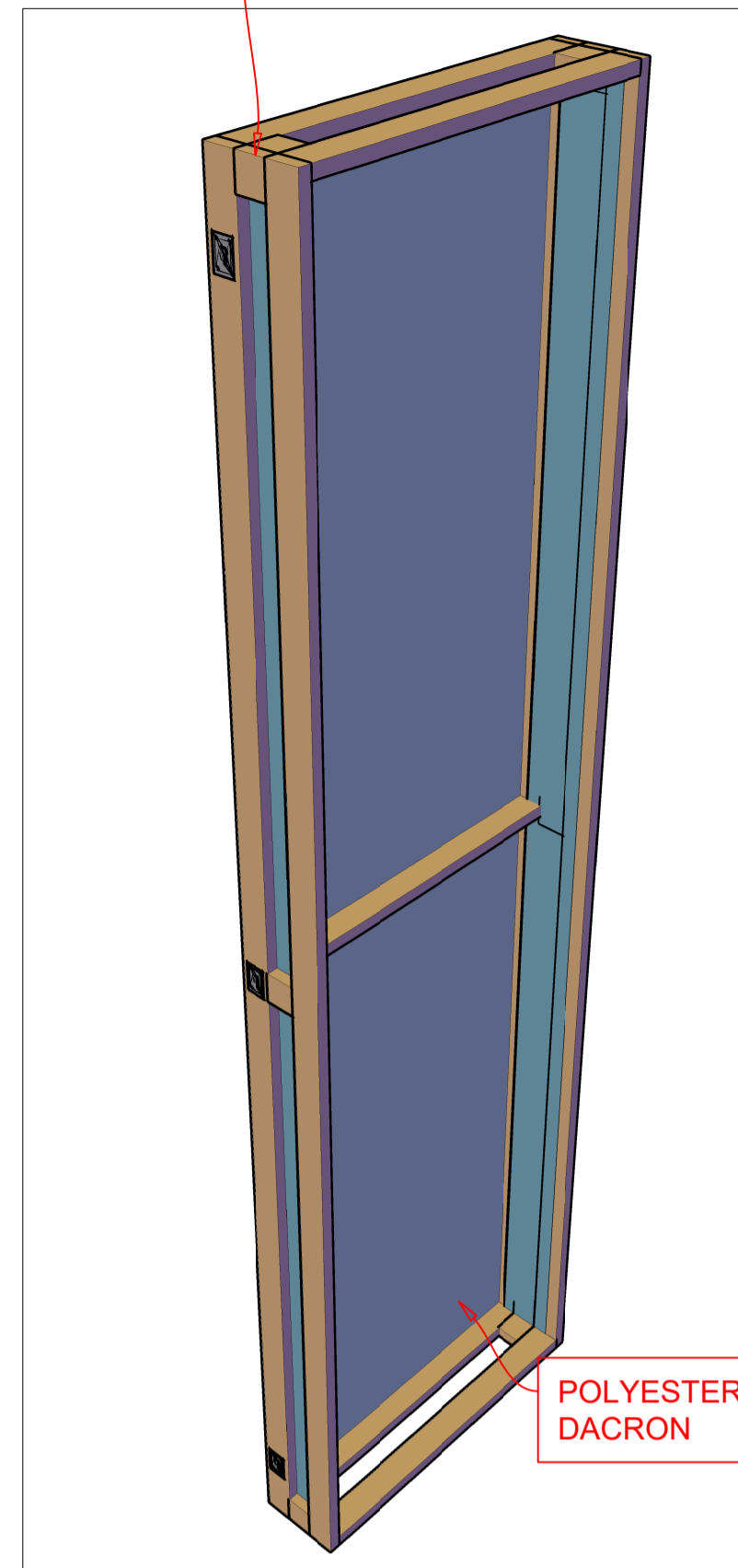

SIDE & CORNER BLOCKING

POLYESTER / DACRON

3. INSTALL CENTER BRACE AND ADD 1/4" (6 mm) DACRON / POLYESTER BATTING AGAINST FRONT FABRIC

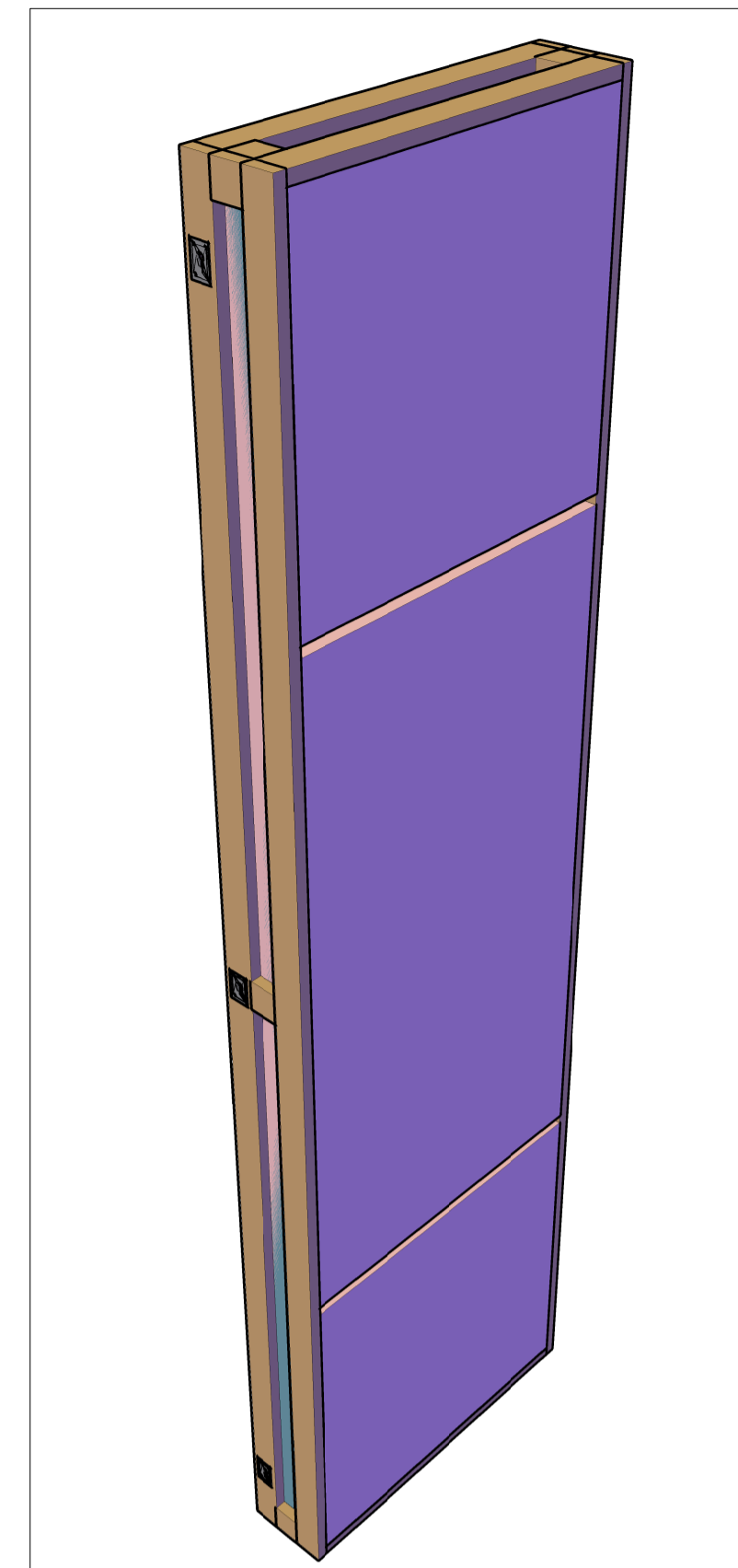

4. FILL WITH FIBER PRODUCT

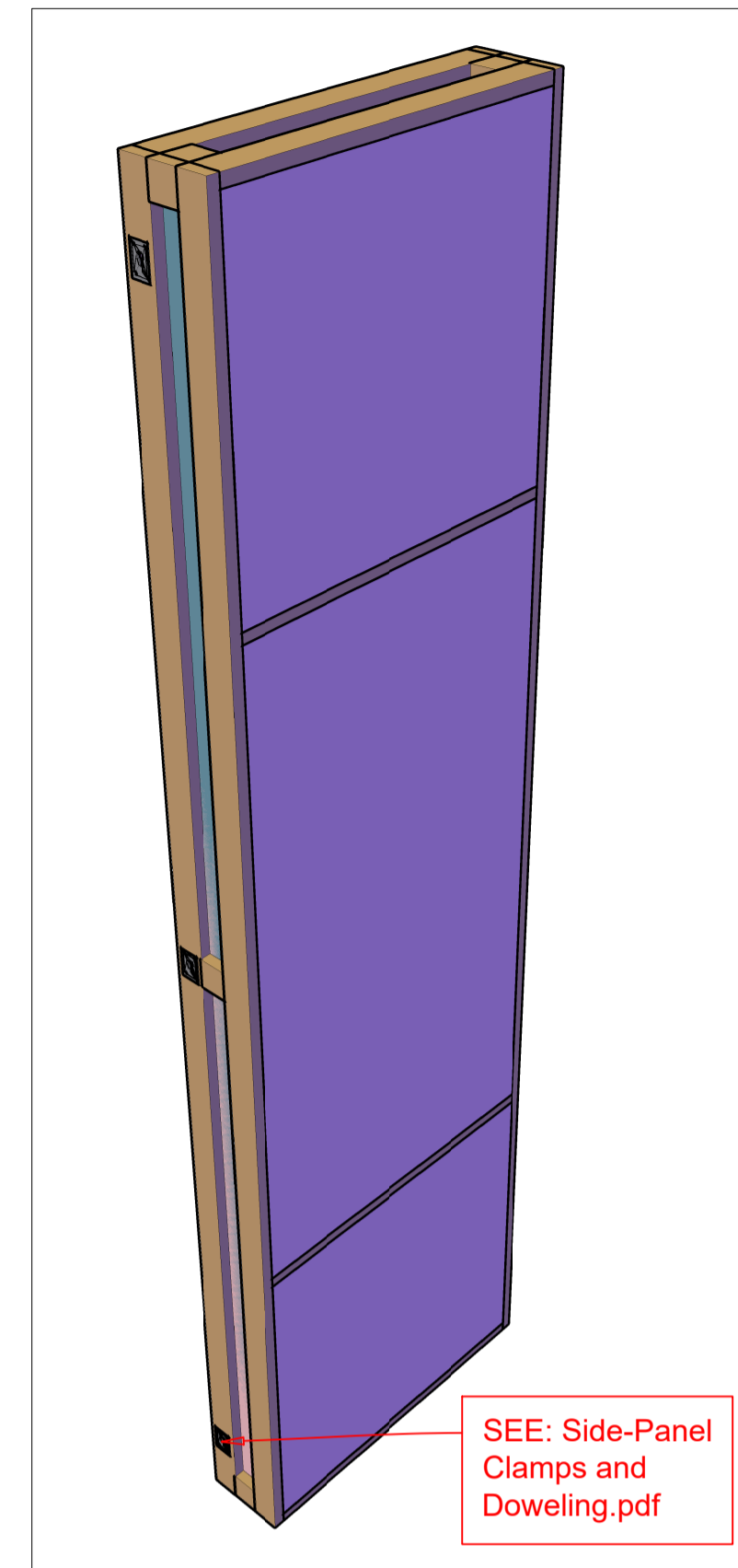

SEE: Side-Panel Clamps and Doweling.pdf

5. INSTALL REAR BRACING

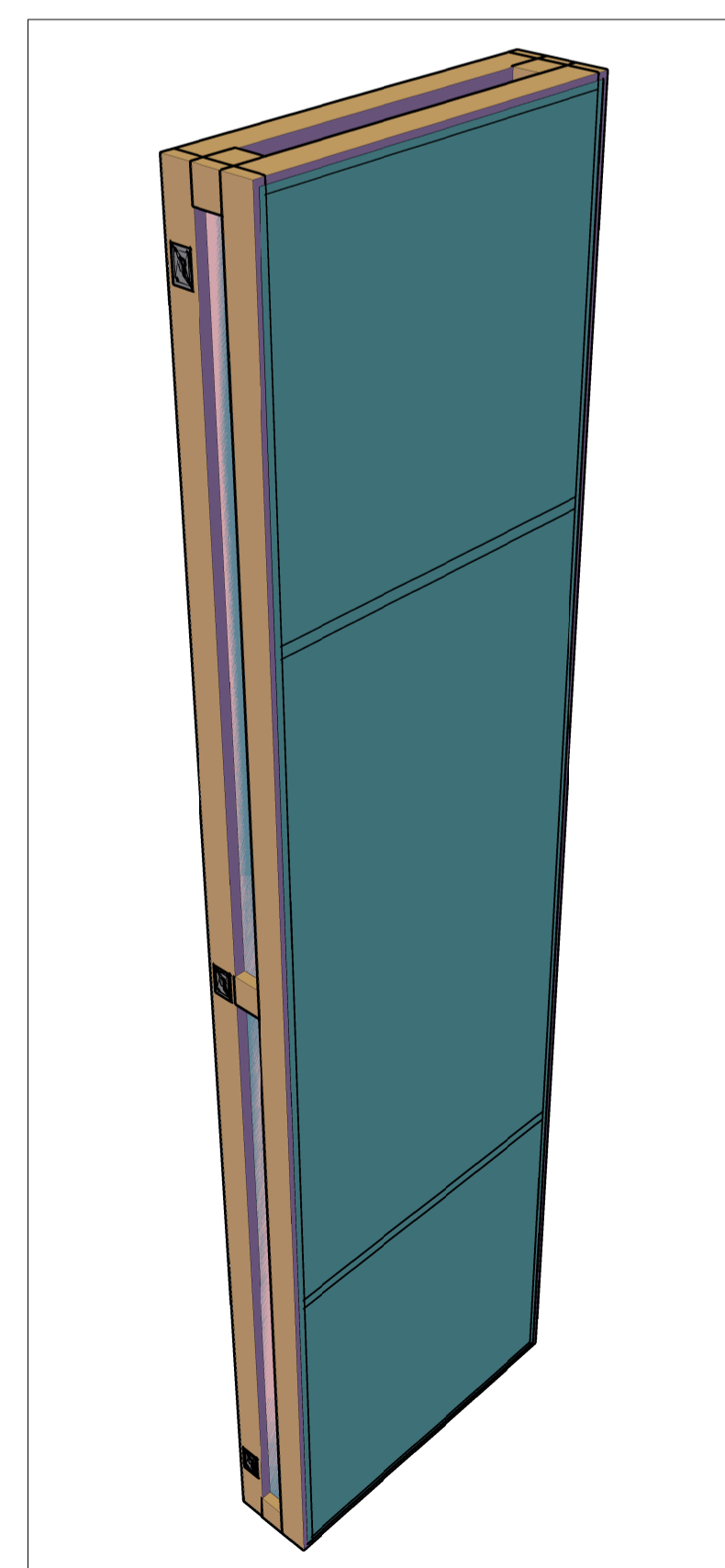

6. COVER THE BACK OF THE UNIT WITH INEXPENSIVE TICKING FABRIC TO KEEP THE COMPONENTS STABLE DURING SHIPPING AND INSTALLATION.

ALL TREATMENT IS ASSEMBLED USING DOWEL AND GLUE METHOD

THIS DRAWING IS PROPERTY OF JH BRANDT CONSULTANTS AND AS AN INSTRUMENT OF SERVICE, MAY NOT BE ALTERED, REPRODUCED, COPIED OR USED FOR CONSTRUCTION WITHOUT THE WRITTEN PERMISSION OF JH BRANDT. © 2020 all rights reserved.

Draftsman: John H. Brandt	Date: 05/25/2020
Drafter:	Date:
Revision/Issue:	Date:
Revision/Issue:	Date:

This drawing is to be printed on standard A1 paper (564 mm X 841 mm) if not, DO NOT SCALE. Scale Metric: 1 : 8

ASSEMBLY  
 Job No : 10864 Project Date: 05/25/2020  
 Sheet :