

POLYESTER DACRON  
A-A (1:8)

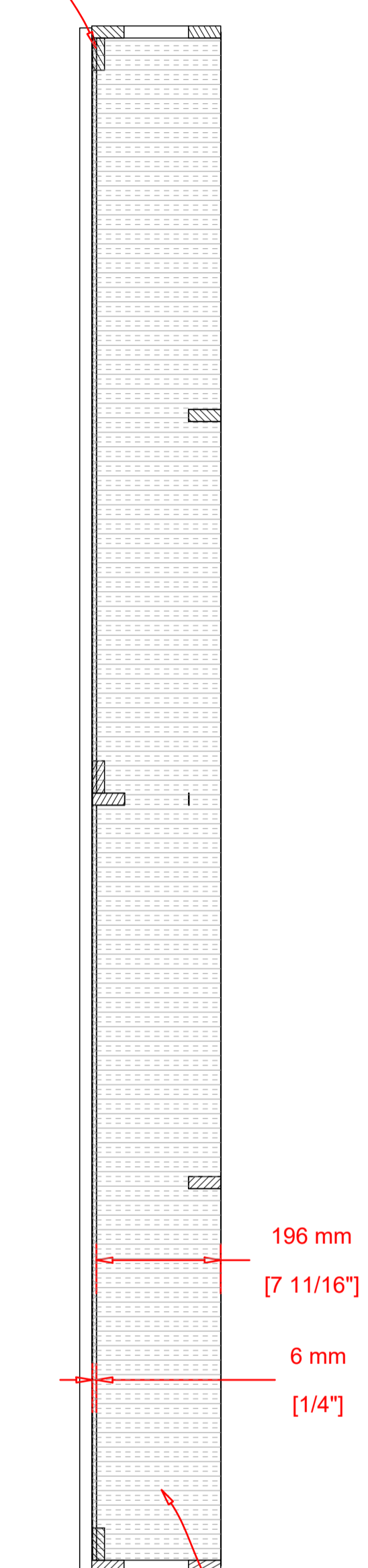

OWENS CORNING "PINK"

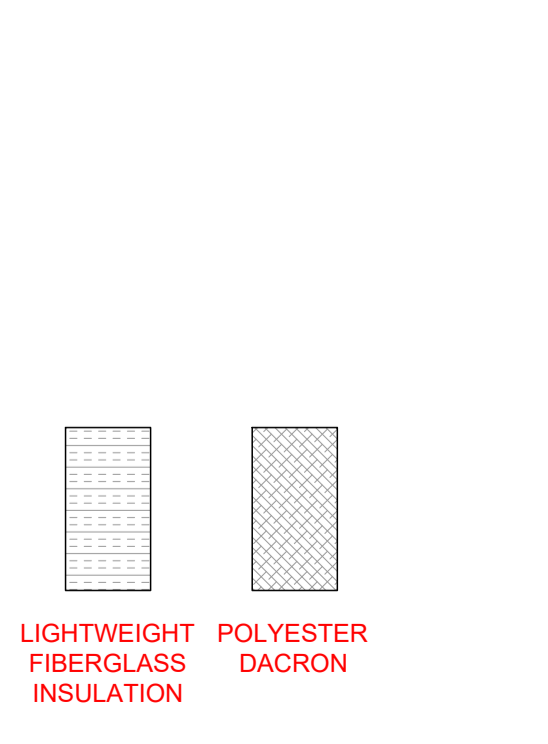
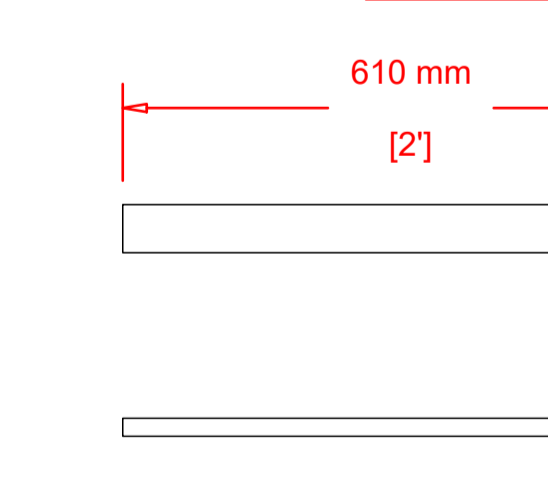

LIGHTWEIGHT FIBERGLASS INSULATION  
POLYESTER DACRON

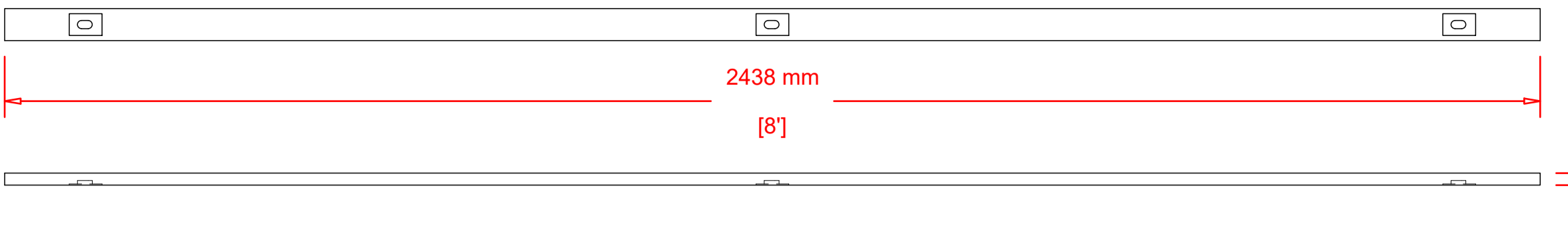
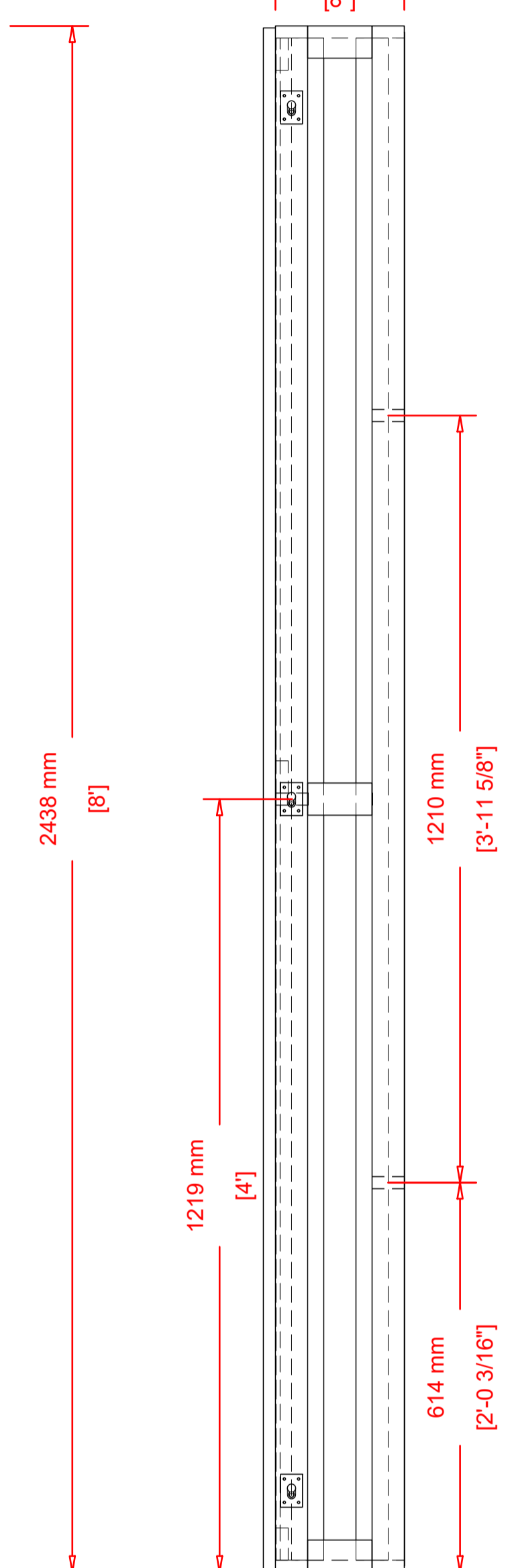
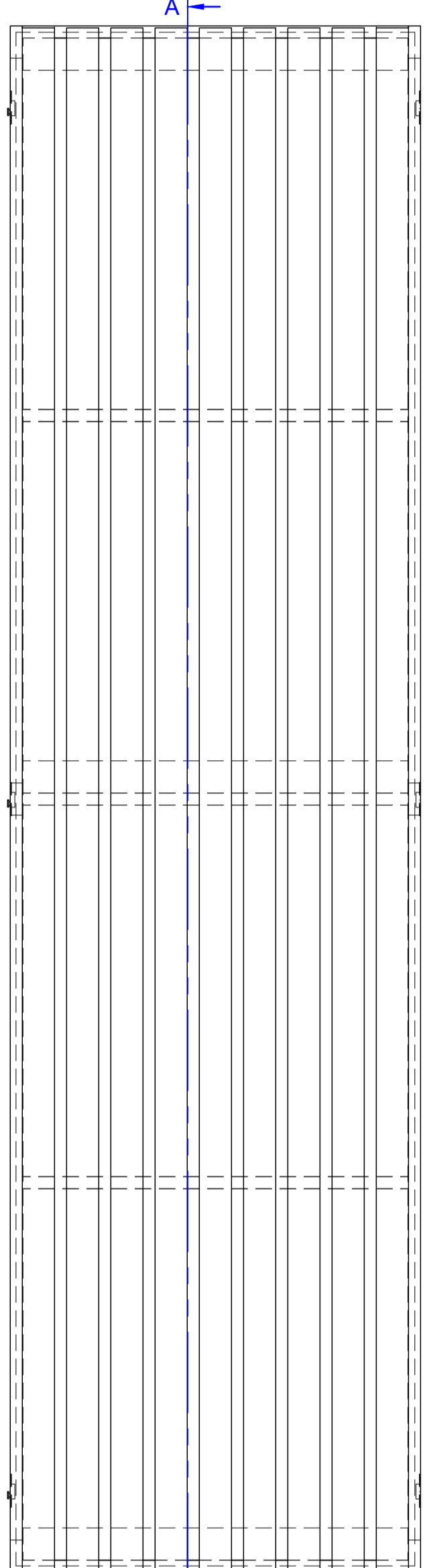
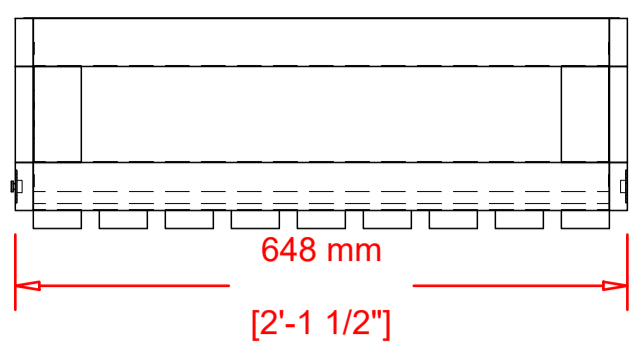

SEE: Side-Panel Clamps and Doweling.pdf

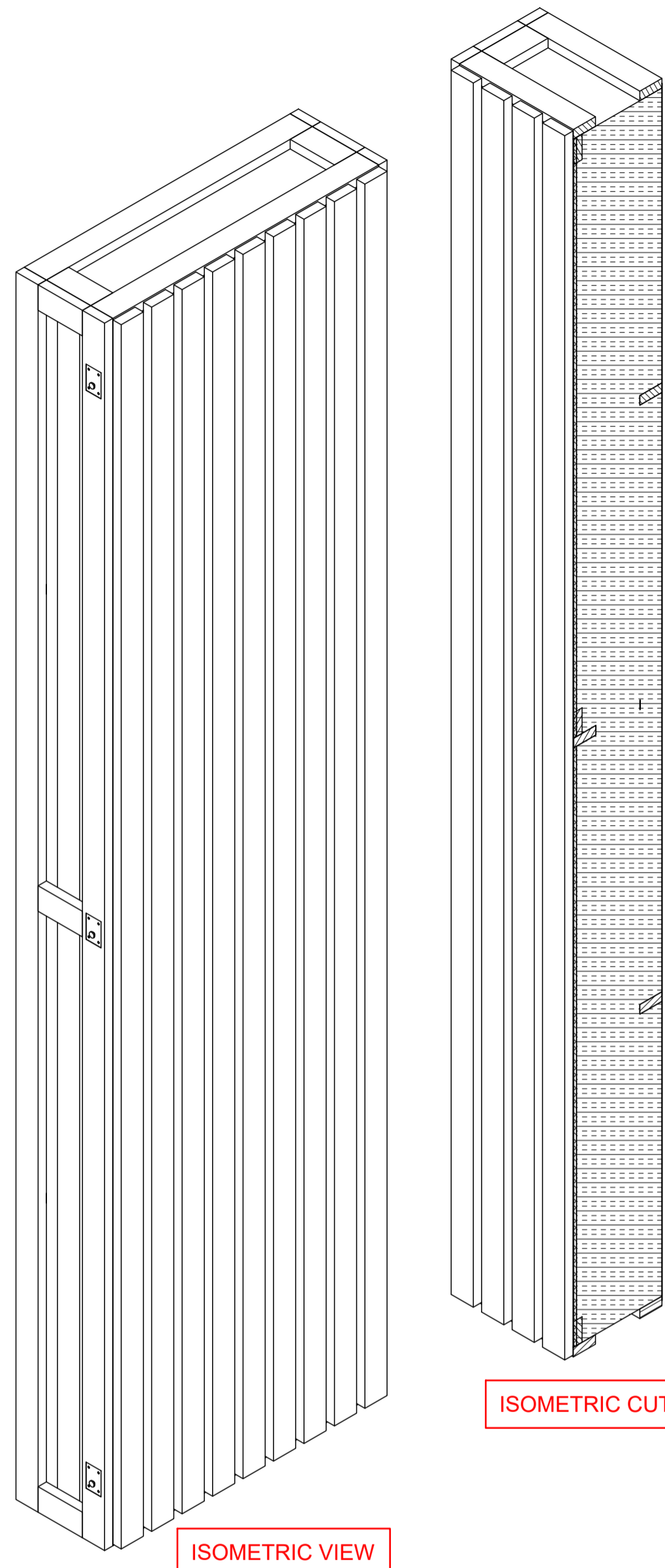
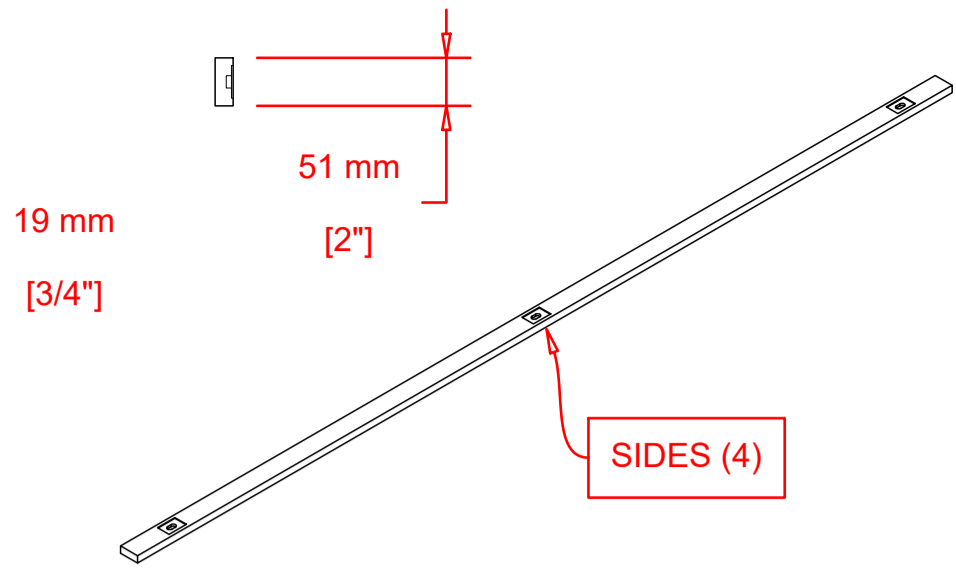

# NWAA Labs, Inc.

90 Tower Blvd,  
Elma, WA 98541 (253)-973-1018

Test #	NWAB230508	02
Test Date:	2023-05-08	
Mounting per ASTM E795-00:	A Mount	
Area Tested: M <sup>2</sup>	11.15	
Room Condition	Empty	Full
Temperature: °C	21	21
Barometer: pa	99500	99600
Humidity: %	63	62

NRC	1.00
SAA	0.96

10 by 12, OC Pink R-19, 8 inch, .66 lb per cu ft

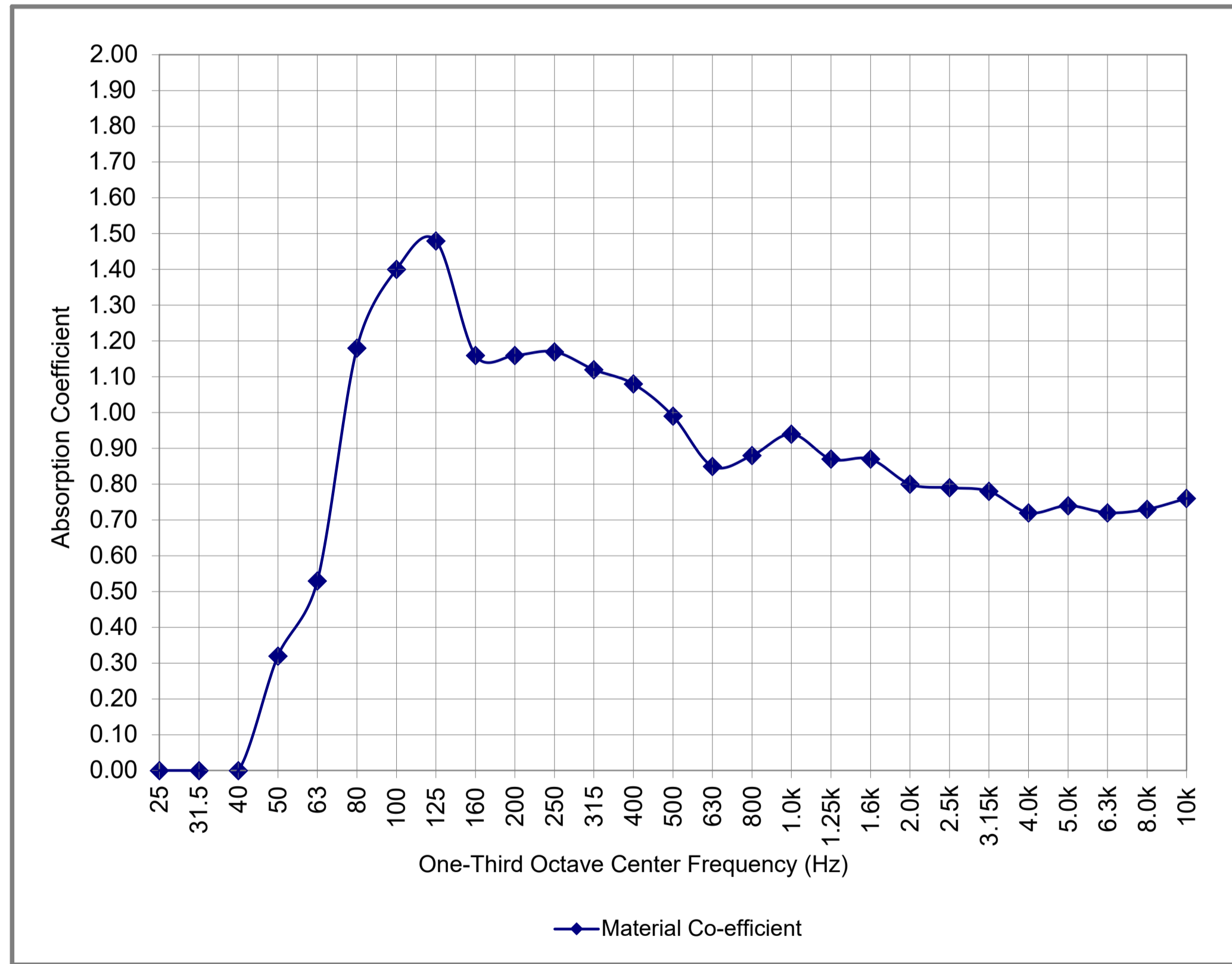

208

Recording Studio,  
Performance Hall, &  
Architectural Acoustics  
Consultants  
**JH BRANDT**  
Sumnerwood Bldg., Chubbuck Lotus, IA 20  
Bekasi, West Java, Indonesia  
email: jhbrandt@jhbrandt.net  
tel: +62 21 205 734 88 / +62 821 7771 9978  
web site: http://www.jhbrandt.net

THIS DRAWING IS PROPERTY OF  
JH BRANDT  
AND AS AN INSTRUMENT OF  
SERVICE, MAY NOT BE ALTERED,  
REPRODUCED, COPIED OR USED  
FOR CONSTRUCTION WITHOUT  
THE WRITTEN PERMISSION OF  
JH BRANDT.  
© 2020 all rights reserved.

Drafter: John H. Brandt	Date: 05/25/2020
Drafter:	Date:
Drafter:	Date:
Revision/Issue:	Date:
Revision/Issue:	Date:

This drawing is to be printed on standard A1 paper (567 mm X 841 mm) if not, DO NOT SCALE. Scale Metric: 1:8

PARTS LAYOUT

Job No: 10864  
Project Date: 05/25/2020

Sheet:

1 of 2

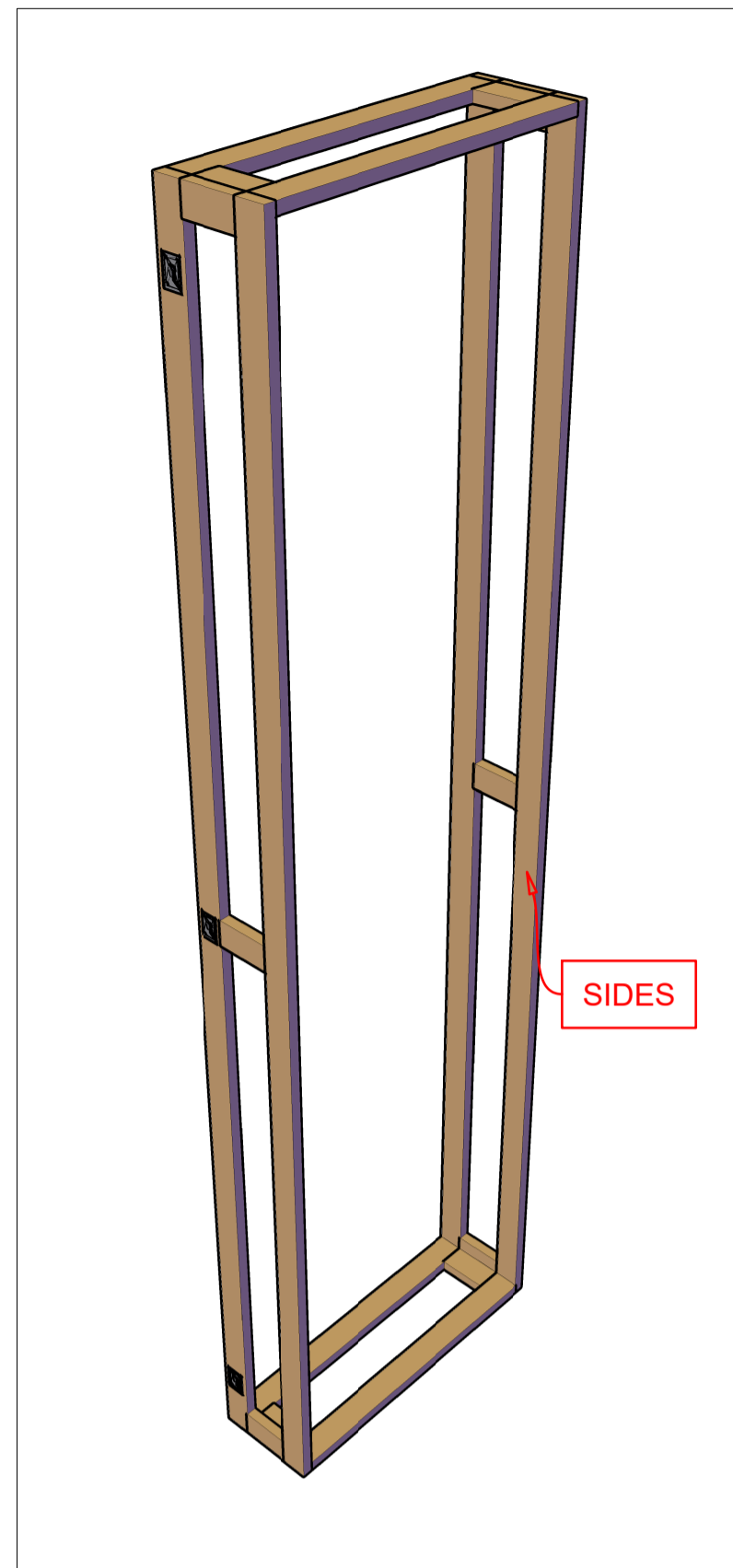

SIDES

1. ASSEMBLE TOP, BOTTOM, AND SIDES USING DOWELS AND GLUE. MAKE SURE THE UNIT IS 'SQUARE' (90 DEGREE CORNERS).

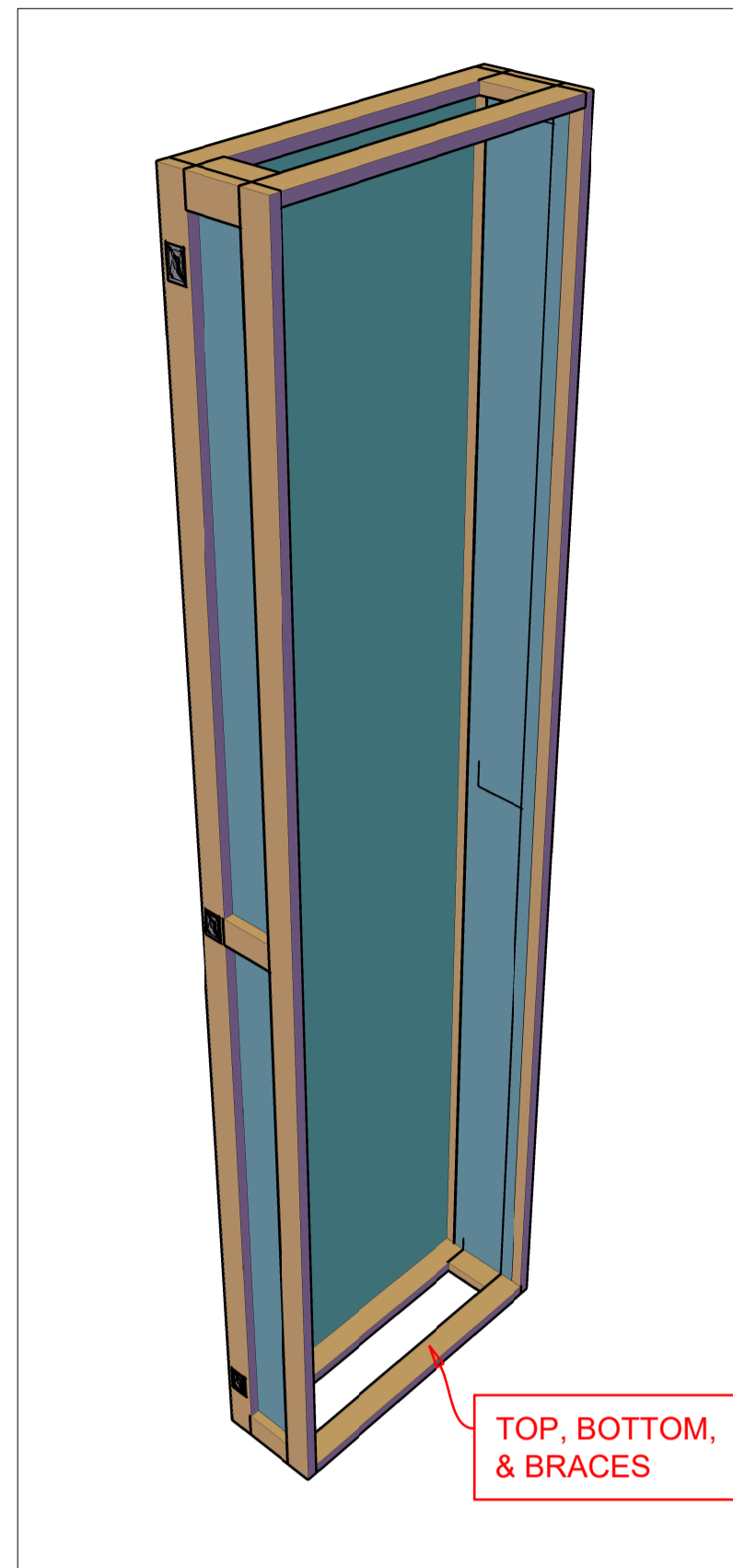

TOP, BOTTOM, & BRACES

2. ATTACH FABRIC TO THE INSIDE OF THE FRAME USING UPHOLSTERERS TAPE OR THIN STRIPS OF PLYWOOD.

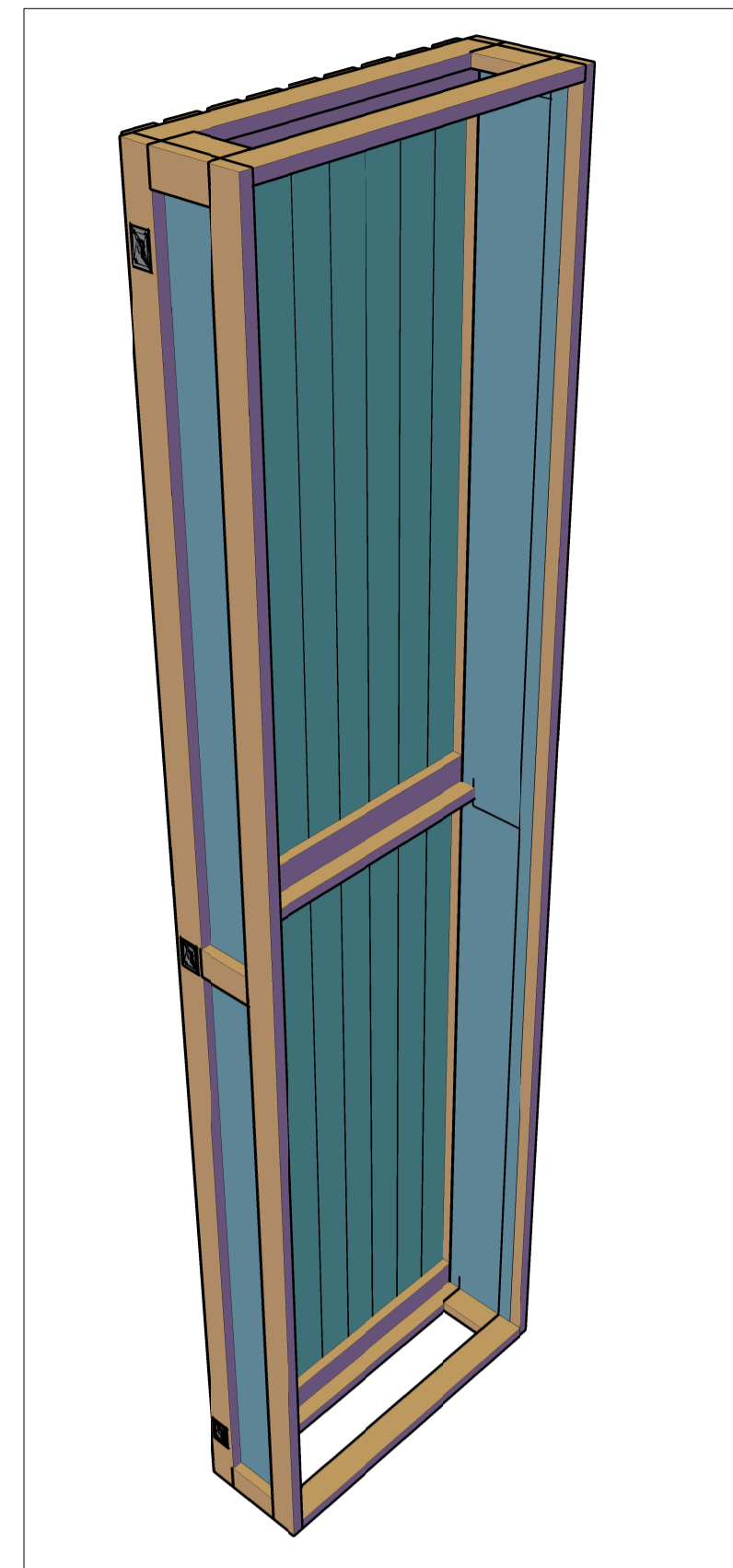

3. ADD CENTER FRONT BRACES AND SLATS

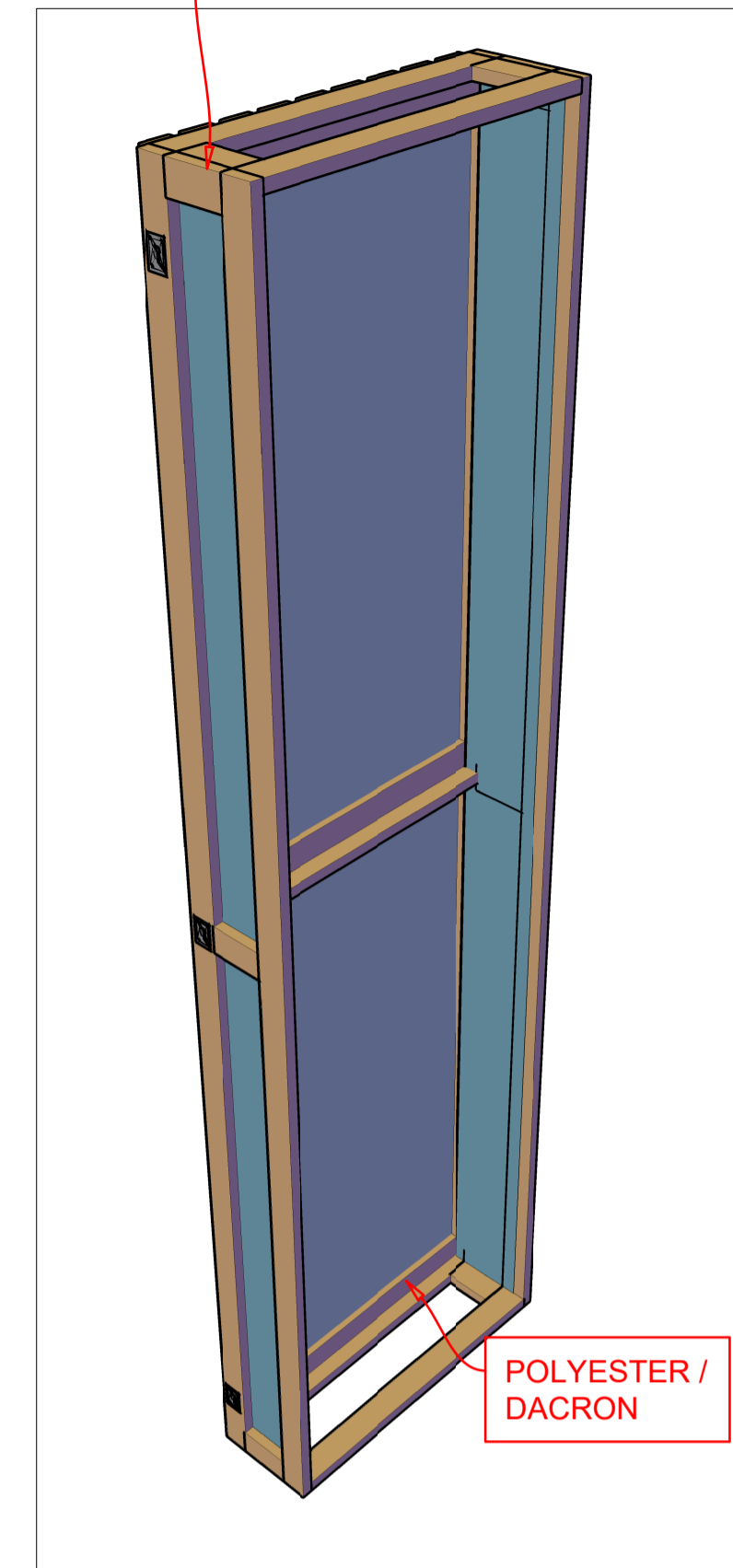

SIDE & CORNER BLOCKING

POLYESTER / DACRON

4. ADD 1/2" (13 mm) DACRON / POLYESTER BATTING AGAINST FRONT FABRIC

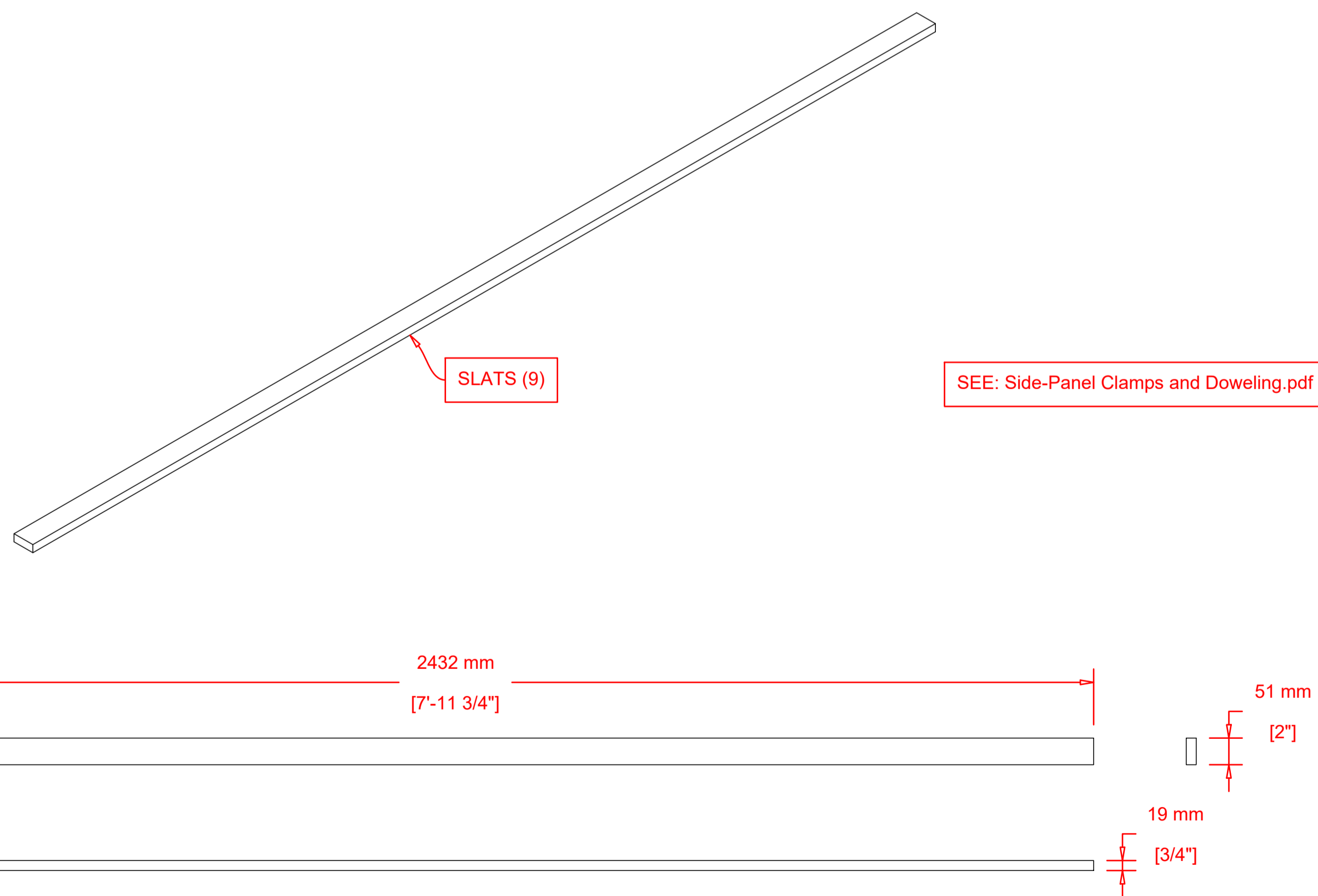

SLATS (9)

SEE: Side-Panel Clamps and Doweling.pdf

5. INSTALL LIGHTWEIGHT FIBERGLASS

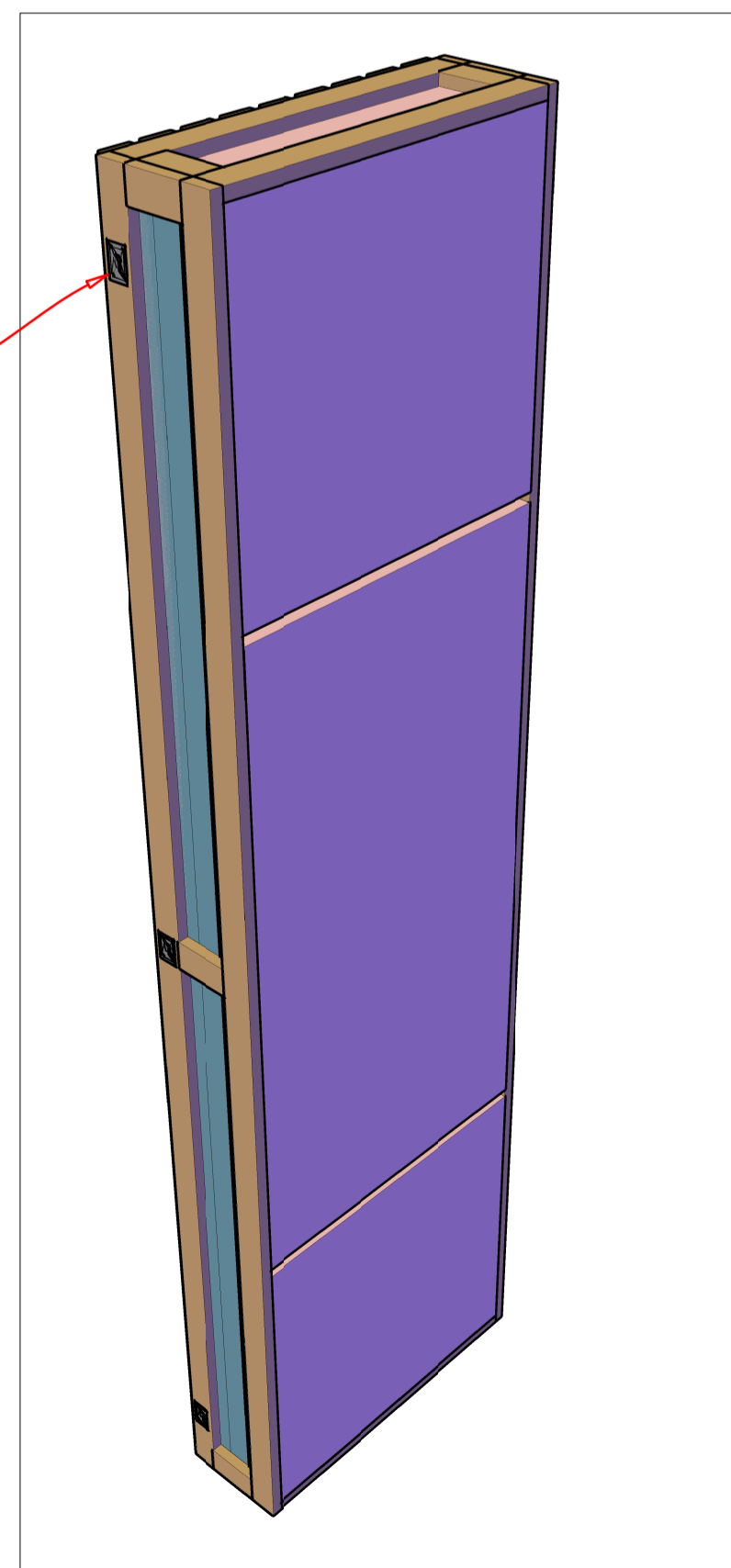

6. ADD REAR BRACING

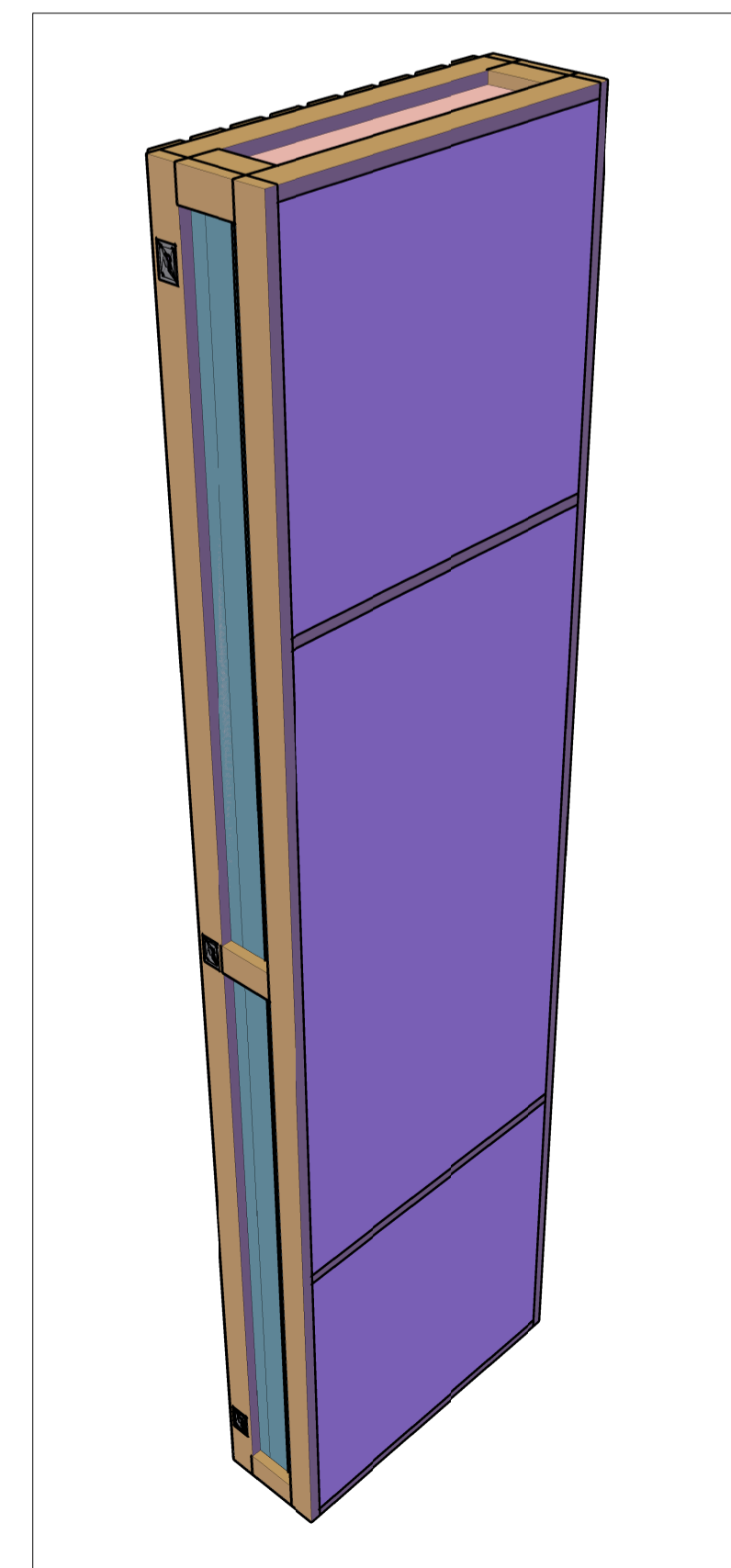

7. COVER THE BACK OF THE UNIT WITH INEXPENSIVE TICKING FABRIC TO KEEP THE COMPONENTS STABLE DURING SHIPPING AND INSTALLATION.

ALL TREATMENT IS ASSEMBLED USING DOWEL AND GLUE METHOD

Recording Studio, Performance Hall, & Architectural Acoustics Consultants  
**JH BRANDT**  
 Recording Studio, Performance Hall, & Architectural Acoustics Consultants  
 Summarecon Bekasi, Cikiter Lokus, A-20 Bekasi, West Java, Indonesia  
 email: jhbrandt@jhbrandt.net  
 tel: +62 21 205 734 88 / +62 811 7771 9778  
 web site: http://www.jhbrandt.net

THIS DRAWING IS PROPERTY OF JH BRANDT AND AS AN INSTRUMENT OF SERVICE, MAY NOT BE ALTERED, REPRODUCED, COPIED OR USED FOR CONSTRUCTION WITHOUT THE WRITTEN PERMISSION OF JH BRANDT. © 2020 all rights reserved.

Drafter: Juhri H. Brandt	Date: 05/25/2020
Drafter:	Date:
Revision/Issue:	Date:
Revision/Issue:	Date:

Job No : 10864  
 Project Date : 05/25/2020